

UPLIFT DESK® View™ Dual Monitor Arm Instructions ACC302

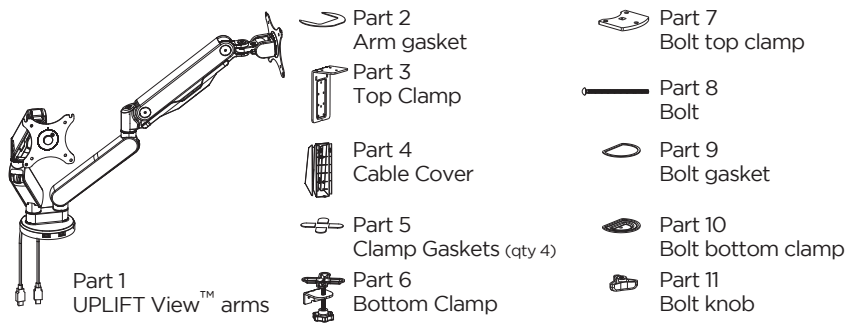

Screws & Tools

- Part A: M4x12mm screws (qty 8)
- Part B: M5x12mm screws (qty 8)
- Part C: M6x12mm screws (qty 3)
- Part D: M6x14mm screws (qty 2)
- Part E: Washers (qty 16)
- Part F: Allen wrench (small)
- Part G: Allen wrench (large)

There are two ways to attach your UPLIFT View™ Dual Monitor Arm to your desktop: Clamp and Bolt-thru assembly.

Clamp Assembly - Attach the arm to the back of your desk

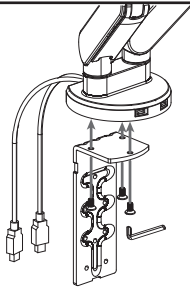

Clamp Step 1

Connect the top clamp (part 3) to the Adapt View™ arm assembly using the three M6x12mm screws (part C) and the small Allen wrench (part F).

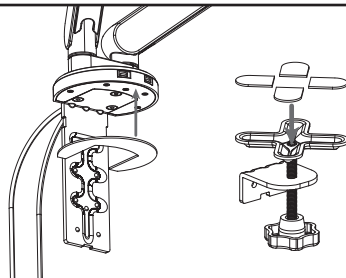

Clamp Step 2

Apply the arm gasket (part 2) under the arm's mount, and the clamp gaskets (part 5) to the bottom clamp (part 6).

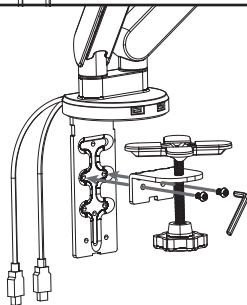

Clamp Step 3

Connect the bottom clamp assembly (part 6) by using M6x14mm (part D) and the small Allen wrench (part F). Affix the Clamp gaskets as shown.

Please select the appropriate mounting holes according to the thickness of the desk.

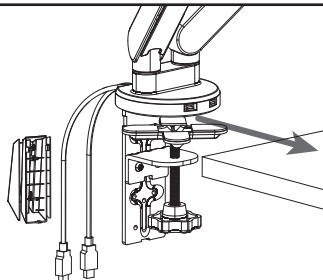

Clamp Step 4

Turn the knobs counterclockwise to loosen them.

Slide the assembly onto your desk and turn the knobs clockwise to tighten the clamp to the desk. **Make sure that the clamp is secure. If the clamp is too loose, the unit may wobble or fall.**

Snap the cable cover (part 4) to the back.

Bolt-Thru Assembly - for holes 8.5mm to 70mm



Bolt-Thru Step 1

Insert the long screw (part 8) into the bolt top clamp. (part 7).

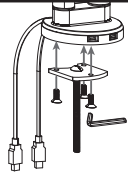

Bolt-Thru Step 2

Connect the assembly to the Adapt View™ arm using the three M6x12mm screws (part C) and the small Allen wrench (part F).

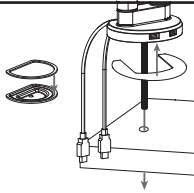

Bolt-Thru Step 3

Place the arm gasket (part 2) under the arm's mount, then slide the assembly into the bolt on your desk. Place the bolt gasket (part 9) onto the bolt bottom clamp (part 10) as shown.

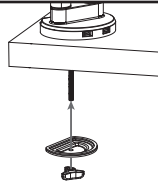

Bolt-Thru Step 4

Slide the bolt bottom clamp (part 10) over the bolt as shown. Screw on the bolt-thru knob (part 11) and tighten, to keep the Adapt View™ arm securely fastened to the desk. **Make sure that the clamp is secure. If the clamp is too loose, the unit may wobble or fall.**

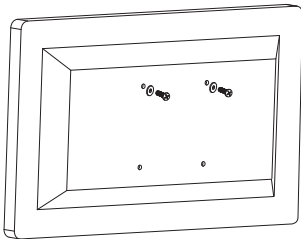

Step 2

Use two washers (part E) and two screws* and screw them in by hand.

*Most monitors will use the M4x12 (part A) screws, but if those seem loose to you, use the M5x12 (part B).

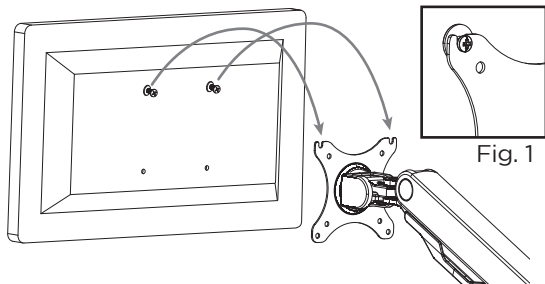

Step 3

Place the monitors onto the on the open holes on the Vesa plate.

See Fig. 1 for specific placement.

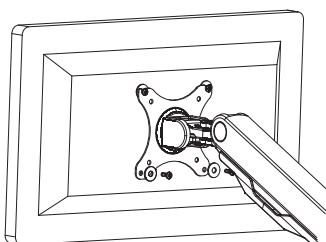

Step 4

Using 2 more washers and screws, screw into the lower two holes on the Vesa mounting plate. (see Fig 2).

Repeat steps 2-4 with your second monitor.

When finished, tighten up all screws from this step and step 2.

Using Cord Management

The UPLIFT Adapt View™ line allows you to run cables from your tray, down the arm, and to the back of your desk.

- Pull the four tabs out of the cable cover on the upper section of the arm
- Pull up and out on the cable cover on the lower section of the arm
- Run your cables through the exposed section of the arm. **Make sure that there is some slack in the cables to allow the arm to freely move.**
- Trap the cables under the cable cover on the upper section of the arm and snap it back into place, and slide the cable cover over the wires in the lower section of the arm

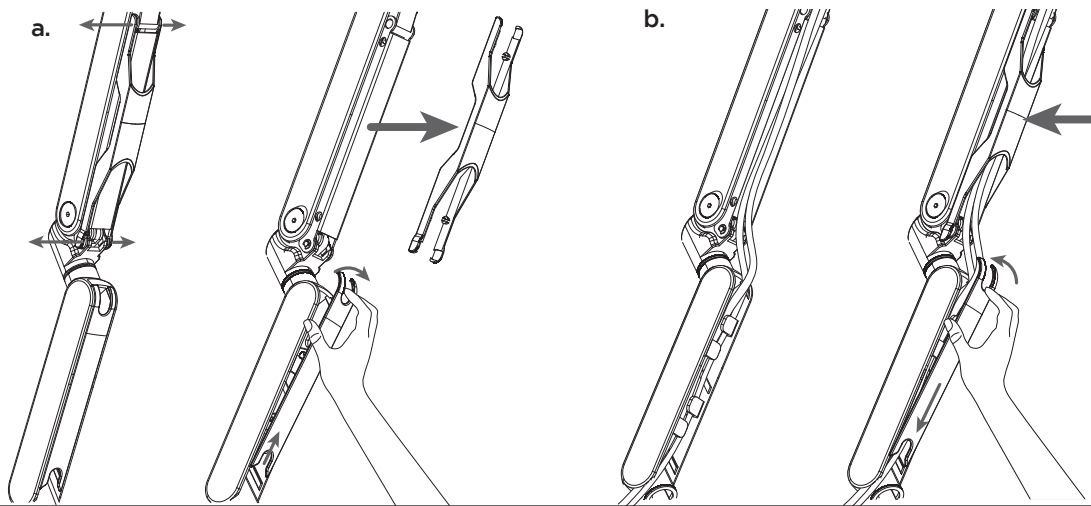

Moving the arm, and counterbalancing

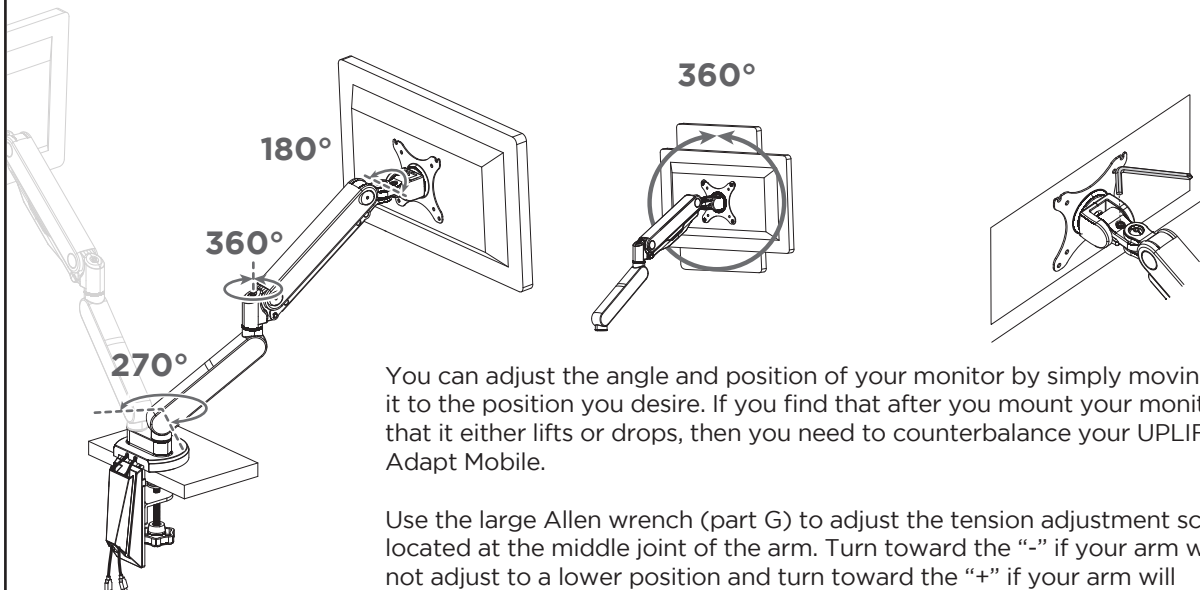

You can adjust the angle and position of your monitor by simply moving it to the position you desire. If you find that after you mount your monitor that it either lifts or drops, then you need to counterbalance your UPLIFT Adapt Mobile.

Use the large Allen wrench (part G) to adjust the tension adjustment screw located at the middle joint of the arm. Turn toward the “-” if your arm will not adjust to a lower position and turn toward the “+” if your arm will not adjust to a higher position. When the arm stays in place after you’ve adjusted it, your UPLIFT Adapt Mobile is properly counterbalanced.

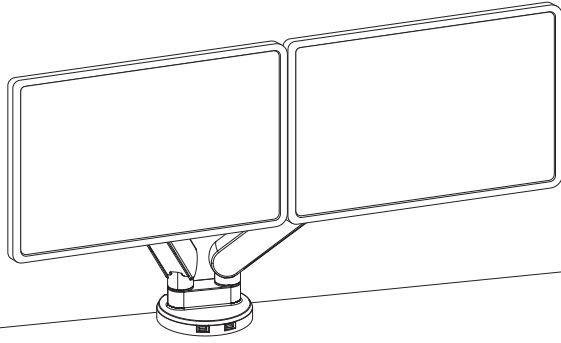

CAUTION

- The maximum load capacity of the UPLIFT Adapt View™ Dual Monitor Arm is 19.8 lbs. **Do not overload.**
- Leave cables slack in the arm assembly to allow the arm room to adjust.
- Secure all clamps and mounts to a stable desktop
- NOT A CHILD'S TOY. Children under 12 must be supervised by an adult while using UPLIFT Adapt View™.
- Failing to follow these assembly instructions and safety precautions may result in personal injury.
- Failing to follow these assembly instructions and safety precautions voids your warranty and may result in property damage.

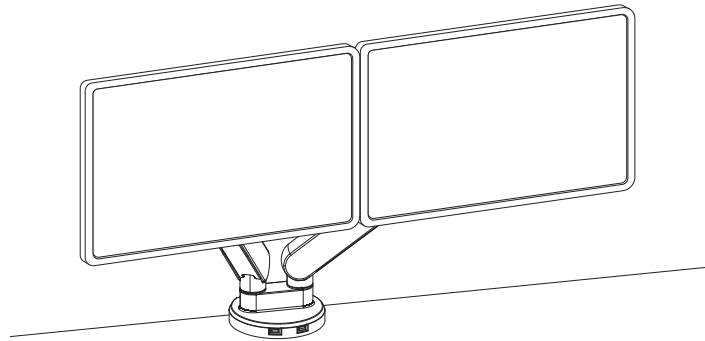

Adapt View™ Dual Monitor Arm

by

UPLIFT DESK®

©

Copyright Notice: These instructions are a component of the UPLIFT View™ Dual Monitor Arm. These instructions are part of the scope of delivery, even if the item is resold. These instructions are also available on the UPLIFT Desk website: upliftdesk.com. Excerpts or copies may not be forwarded to third parties or used in any other published form without the prior written consent of UPLIFT Desk.

These instructions are subject to United States copyright law.