

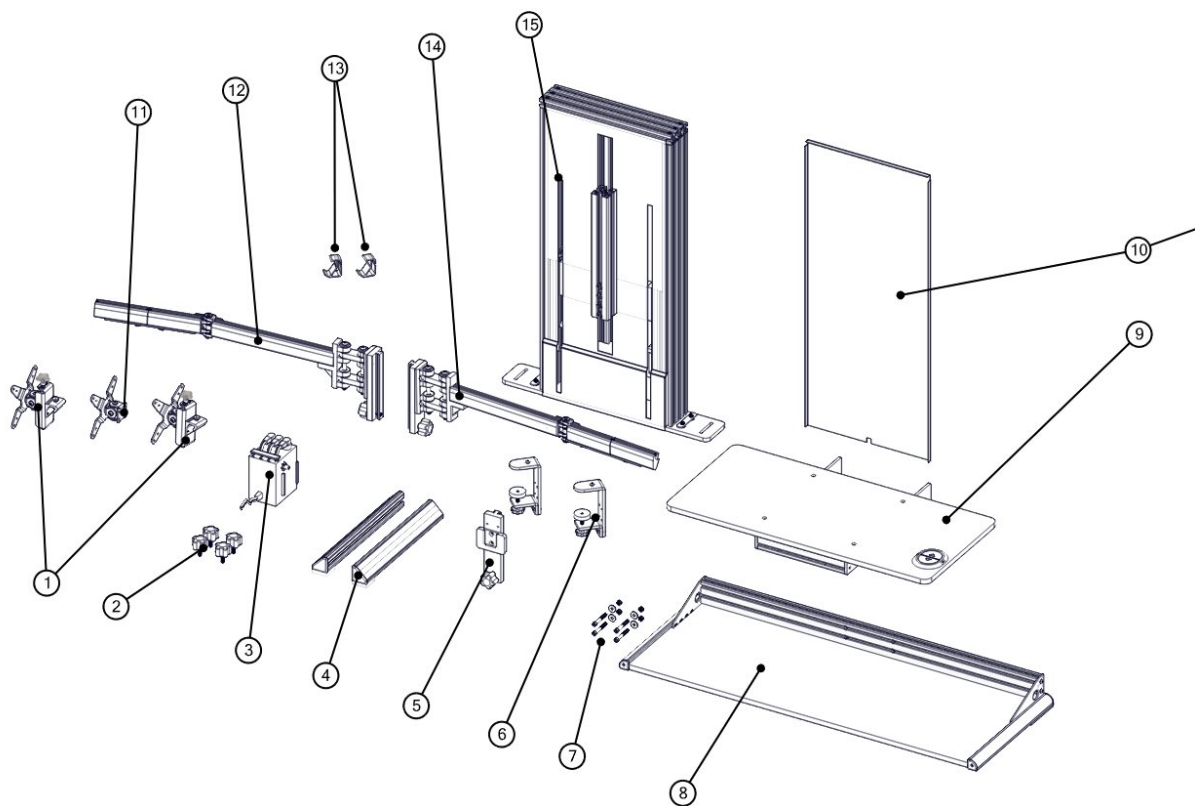

One-Touch Installation Instructions





1	Height Adjustable Pivot w/ screws	9	Upper Work Surface
2	Rail Mount Knobs	10	Back Cover
3	Transformer	11	Center Pivot w/ screws
4	Support Legs	12	Left Monitor Arm
5	Center Pivot Receptacle*	13	Cable Management Clips
6	Clamps*	14	Right Monitor Arm
7	Work surface Attachment Bolts	15	Lift Assembly
8	Lower Work Surface		

**If ordered*

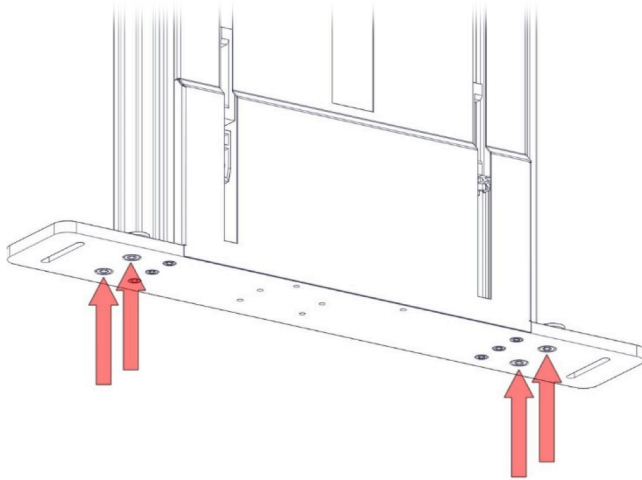

Installing Support Legs

1) Loosen the four 6mm Allen Screws on the underside of the lift assembly. Take care not to remove them fully, just enough to be able to slide the support legs onto the T-Nut. Slide support feet onto T-nuts on lift assembly base. Then re tighten Allen screws securing support legs to base.

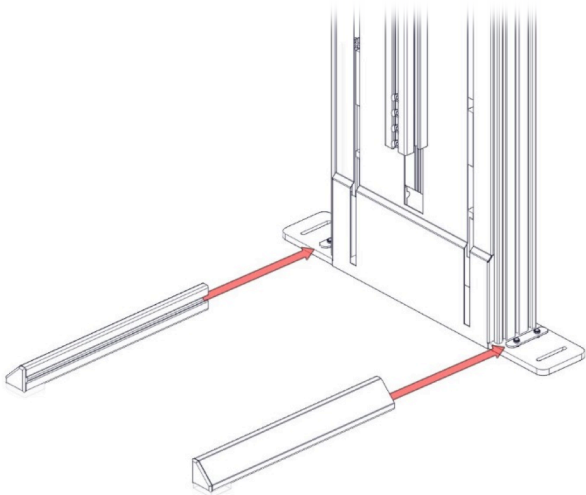

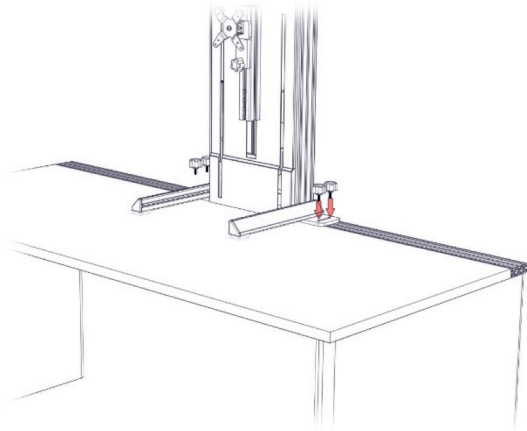

Mounting Options:

Flush Mount

2) Place four M6 T-Nuts in the rail in the approximate locations of the slots on the base of the lift assembly. Use the hex tool provided to align the T-Nuts in the channel more precisely. Position

the
over
and
four

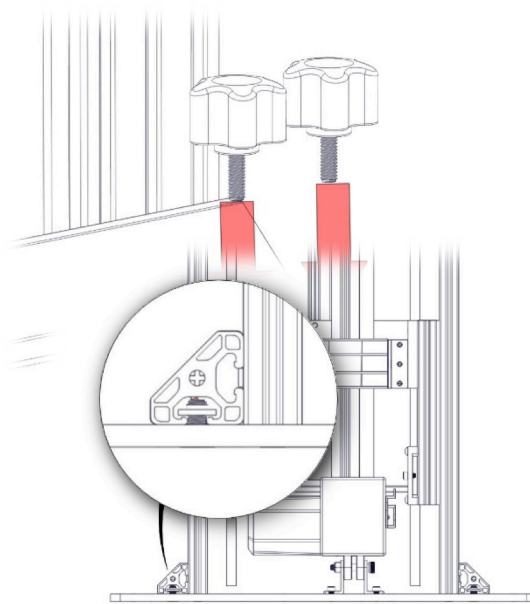
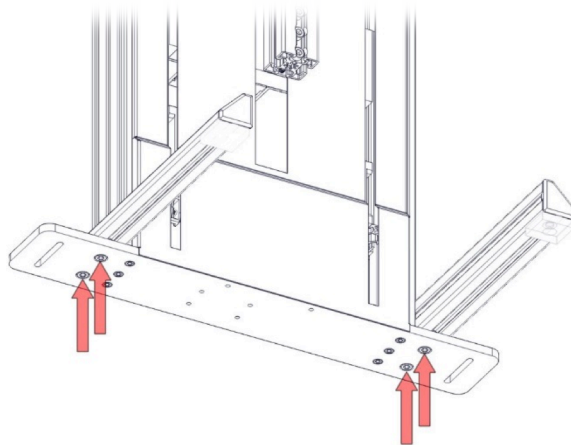

lift assembly
the mount rail
secure with the
supplied
mounting
knobs.

Clamp Mount

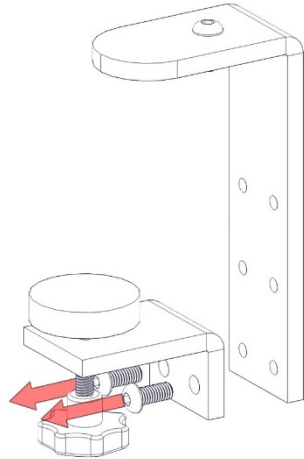

3) Position the lift assembly with the back edge of the lift assembly flush with the back edge of the desk. Position Clamps over slots in base plate, making sure the threaded portion of the button head screw engages the slot as shown in the inset image on the right. If there is a vertical wall directly behind desk, a 3/8" gap is required to install clamp. If this is

the case, the lower bracket will need to be removed from the upper bracket.

4) If there is not a large enough gap between the rear edge of the desk and the wall or obstruction, the clamp must be disassembled to position in place. Remove button head screws holding the upper and lower clamp brackets together.

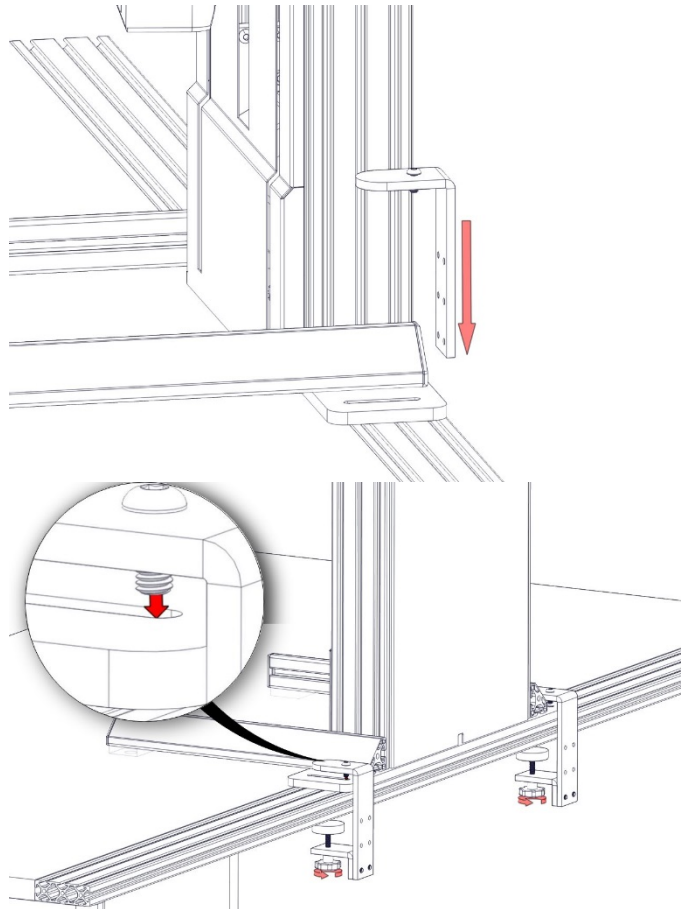

5) Slide the upper clamp bracket behind desk.

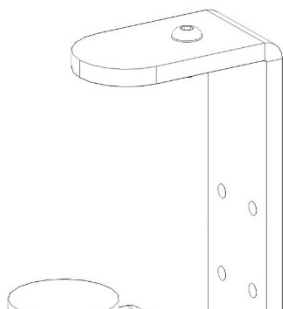

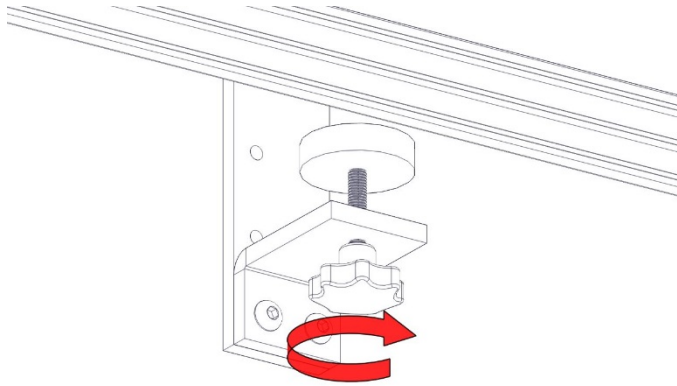

6) Reattach lower bracket to top bracket underneath the desk. Please note there are three sets of mounting holes on the upper bracket to accommodate many different desk thicknesses.

7) Tighten clamp to secure lift assembly to desk.

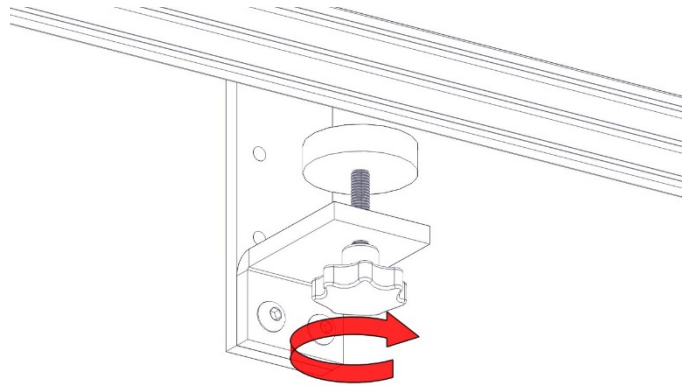

Bracket Mount

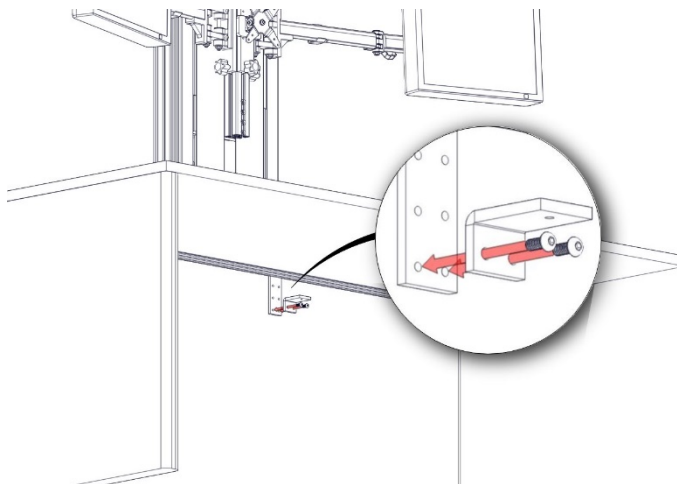

8) To mount to courtesy panel, disassemble clamp and set aside lower bracket assembly. Place upper bracket in position shown and secure to panel with 8 wood screws in the position shown.

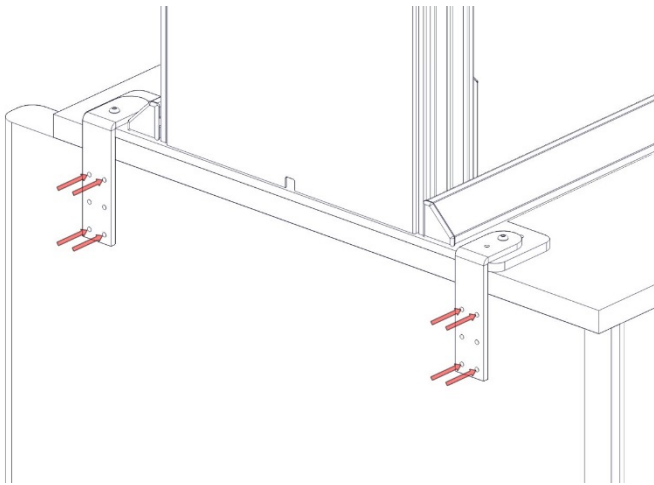

Installing the Work Surfaces

9) Slide the U-shaped bracket into the pockets on the lift assembly with the threaded holes facing up as shown.

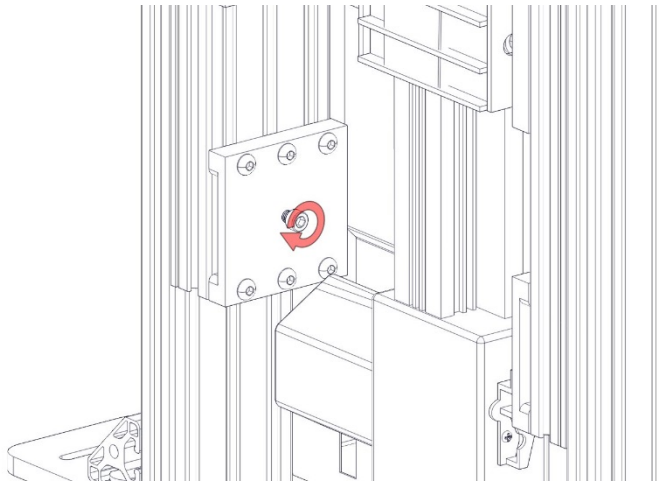
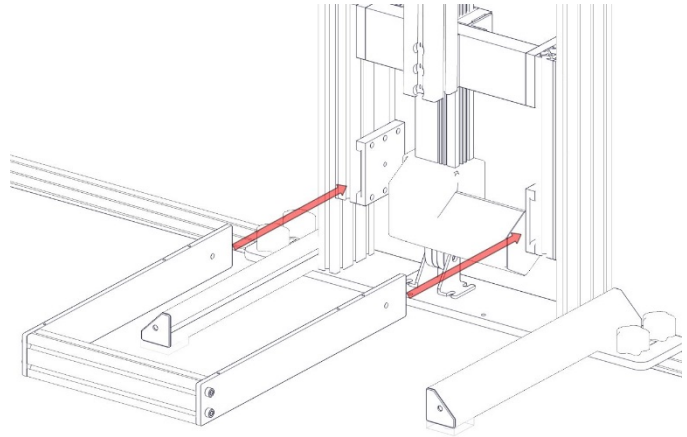

10) Tighten screws on both sides of the pocket using the supplied 5mm wrench.

11) Tilt the larger lower work surface backwards slightly and lower over the bolts on either side of the U-shaped bracket. Once hooks are on the bolt head tilt forward.

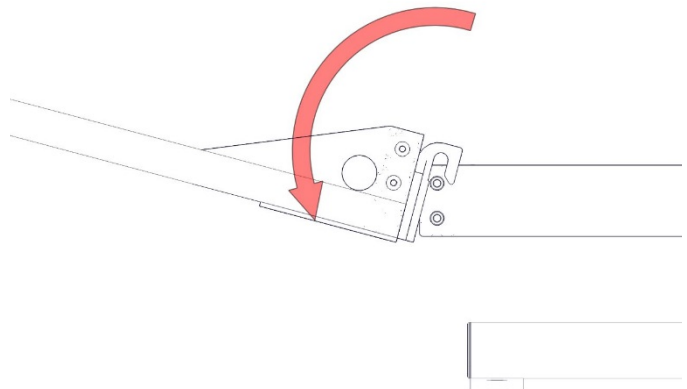

12) Lower the work surface all the way down onto the bolt heads.

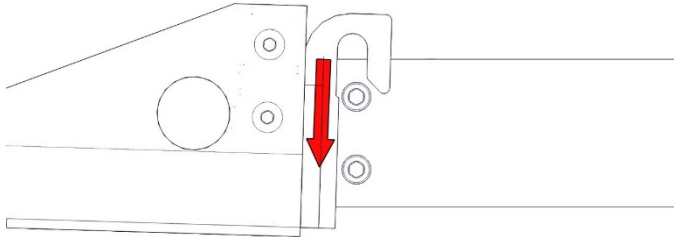

13) Position the upper work surface over the U-shaped bracket with the switch in the lower right hand corner. Insert the four 4mm screws and tighten.

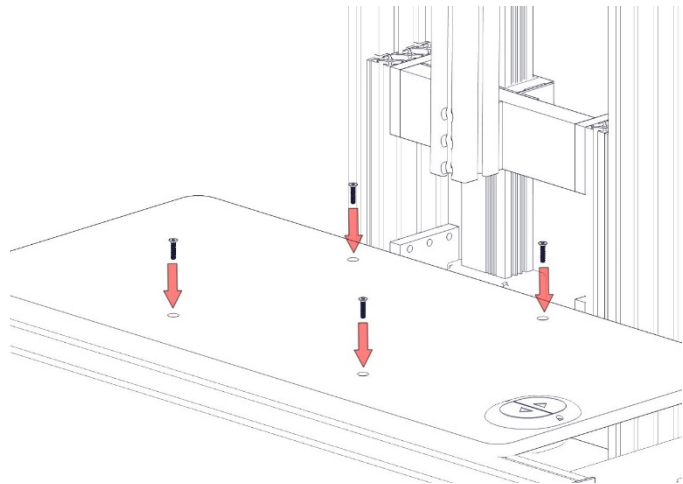

Powering up the Sit Stand

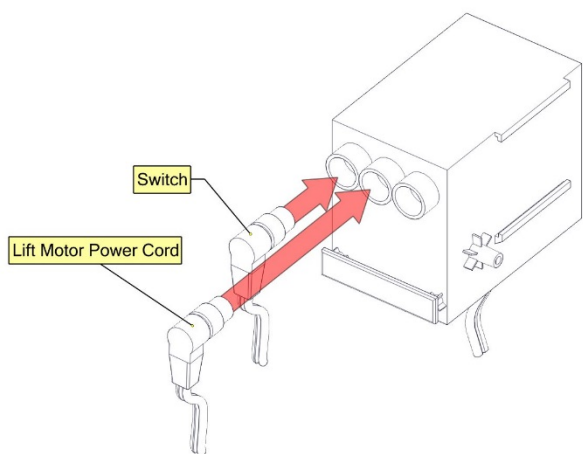

14) Connect the cord coming from the control switch on the upper work surface in the left receptacle of the transformer. Connect the lift motor cord to the center receptacle. (The right receptacle is not used.) Plug power cord from transformer to 110v outlet.

15) Once fully connected, the transformer can be placed between the support legs. Orientation of the transformer is critical to prevent interference with work surface. Place the grooves (indicated by the yellow arrow) facing upward. Center the transformer left to right, about an inch from the lift assembly.

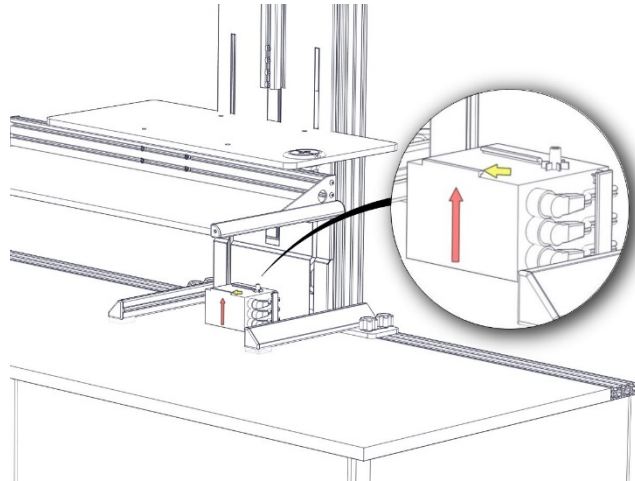

***If installing on a desk equipped with an infield panel, the transformer should be placed there, in a spot that will allow for maximum cable travel as the unit is raised.**

Mounting Monitors

16) Slide right and left arms into the slot on the Pivot mount rail and tighten knob to secure. (Black knob facing down) Repeat with center pivot receptacle if included.

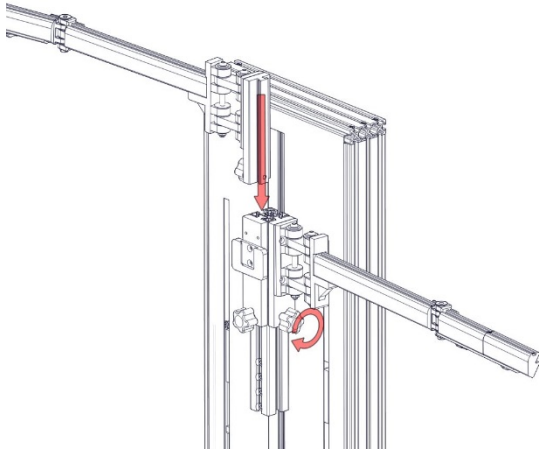

17) Mount the Pivots to the monitors with the provided screws as shown. Note orientation of pivot. The knob should face up.

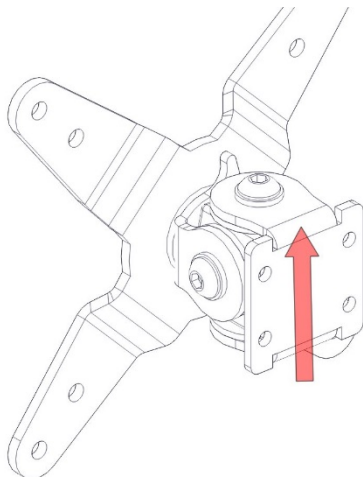
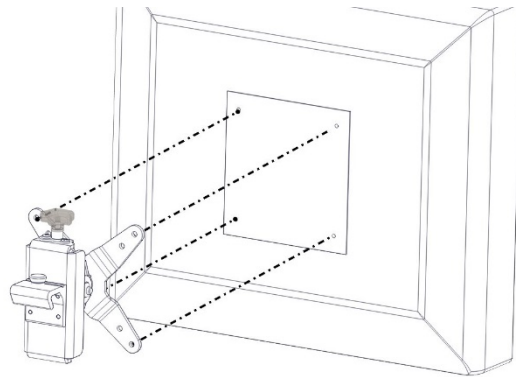

18) If mounting a center monitor, be sure to mount the pivot to the monitor with the tabs in the orientation shown. (Arrow points to top of monitor.)

19) Slide center monitor and pivot into center pivot receptacle. Adjust center monitor to desired height by loosening knob and raising or lowering monitor. Be sure to support weight of monitor when adjusting these knobs!

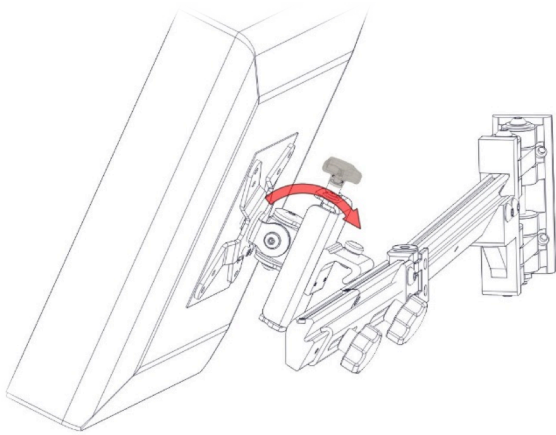
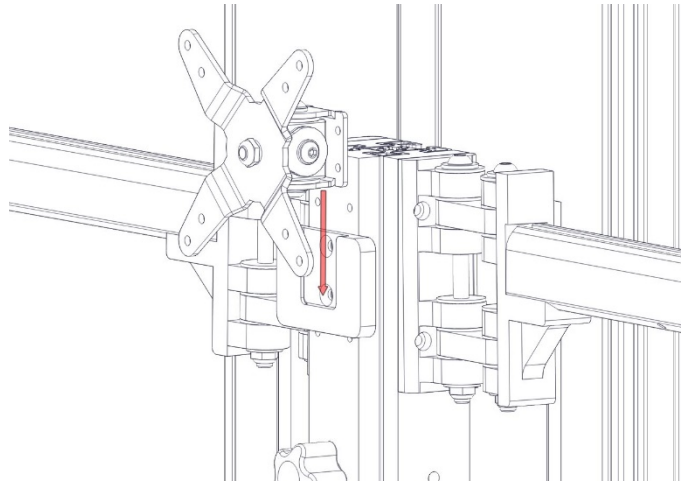

20) To mount the right and left monitors to the arms, tilt the monitor back and position the pivot hook over the bar.

21) With the monitor still tilted backward, lower the monitor in position, hooking the pivot on the bar.

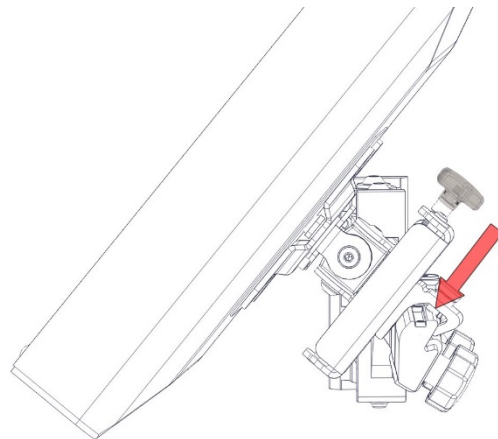

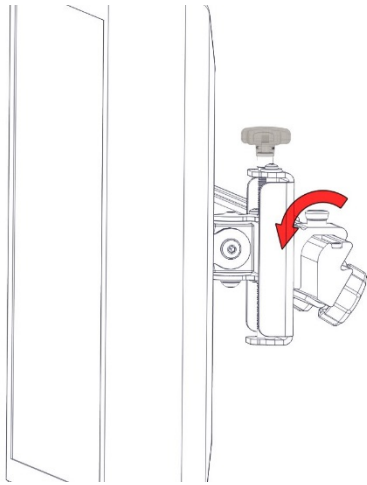

monitor, and slide right or left.

22) Tilt the monitor forwards until it seats on the bar. The quick release pin should make a clicking noise as it engages with the channel on the top of the bar.

To adjust position side to side, tilt upward slightly, unweighting the

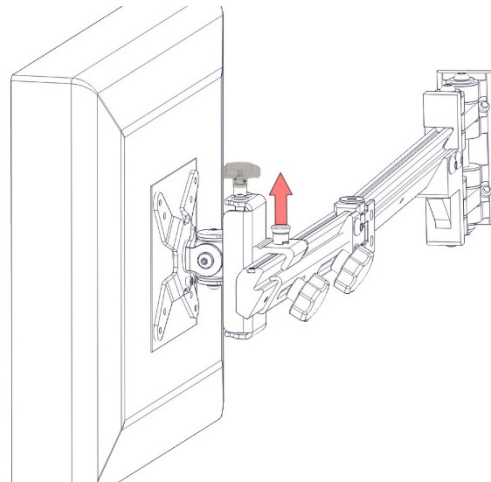

23) To remove monitors, pull up on quick release pin, tilt monitor backward and lift off of bar.

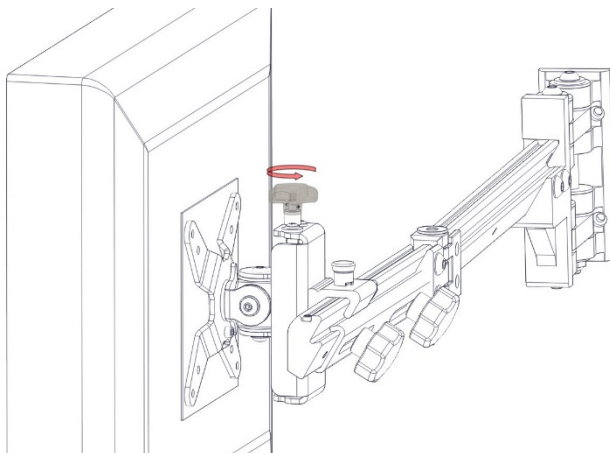

24) To align monitors in the up or down, turn the micro adjustment knob. It may help to lift up slightly on the monitor

when doing this to make the knob easier to turn.

25) Install cable management clips on arm by hooking upper edge into top channel on the bar, then pressing the bottom in place.

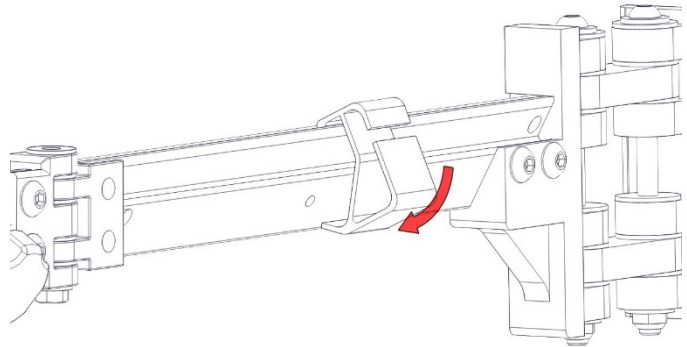

available at:



800.531.3746
info@thehumansolution.com
thehumansolution.com