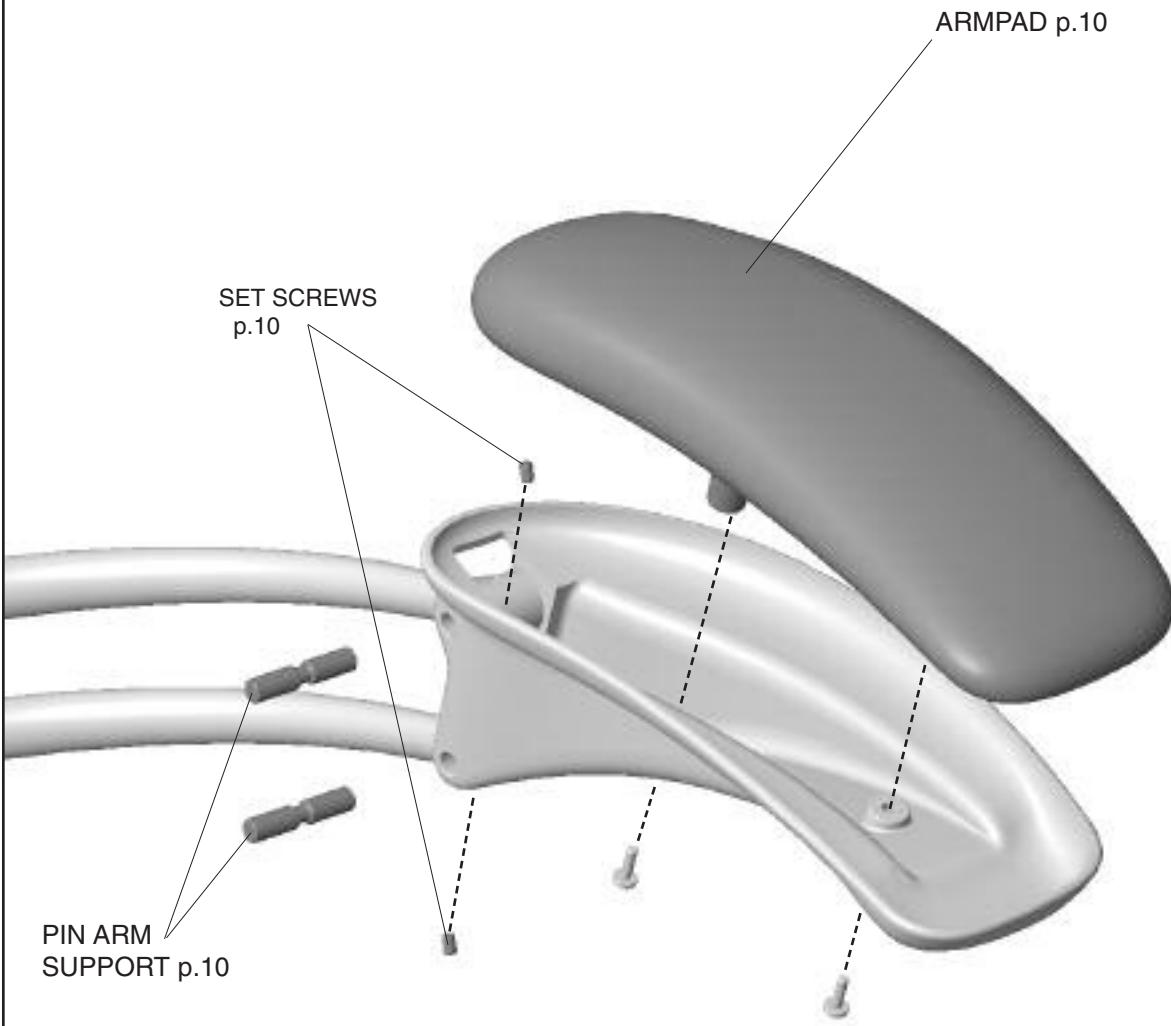

**FIG. 1**





## ARM SUPPORT AND ARMPAD REPLACEMENT

**TOOLS NEEDED:** 5/64" or 3/32" Allen Wrench, T-20 Torx Screwdriver

### Armpad Replacement

*Estimated Repair Time: 2 mins. per armpad.*

1. Raise the arms to their top position.
2. Remove the two screws retaining the armpads.
3. Install new armpads
4. Replace the two screws.

### Arm Support Replacement

*Estimated Repair Time: 5 mins. per arm support.*

1. Raise the arms to their middle position
2. Loosen the set screws retaining the pins in the lower arm until they are flush with the arm casting.
3. Remove the pivot pins.
4. Loosen the set screws in the upper arm by pivoting the arm supports until there is sufficient clearance for the allen wrench to reach into the set screws.
5. Remove the pivot pins.
6. Install the new arm supports by lining up the holes in the upper arm with the upper holes in the arm support and inserting the pivot pins. Tighten the set screws in the upper arm.
7. Line up the holes in the lower arm with the lower holes in the arm support and insert the pivot pins.
8. Tighten the set screws in the lower arm.



available at:



800.531.3746

info@thehumansolution.com  
thehumansolution.com