

**Side View**  
Flush Mount; No Links

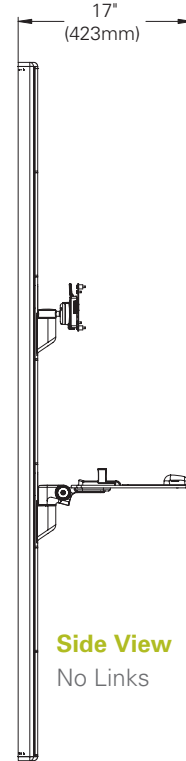

**Side View**  
No Links

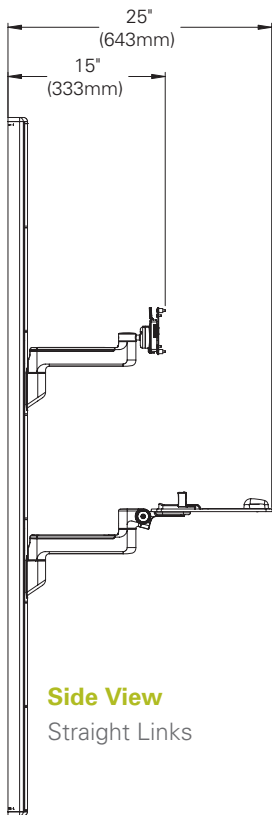

**Side View**  
Straight Links

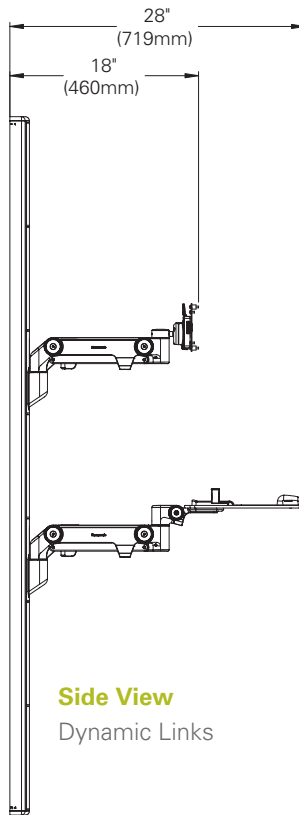

**Side View**  
Dynamic Links

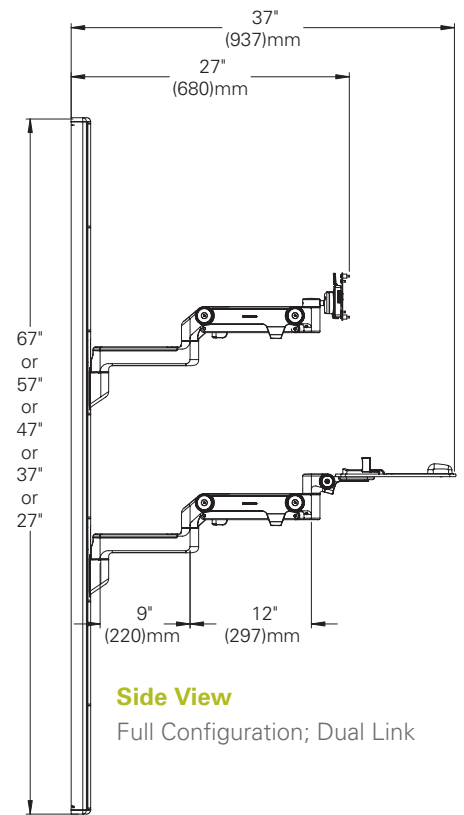

**Side View**  
Full Configuration; Dual Link

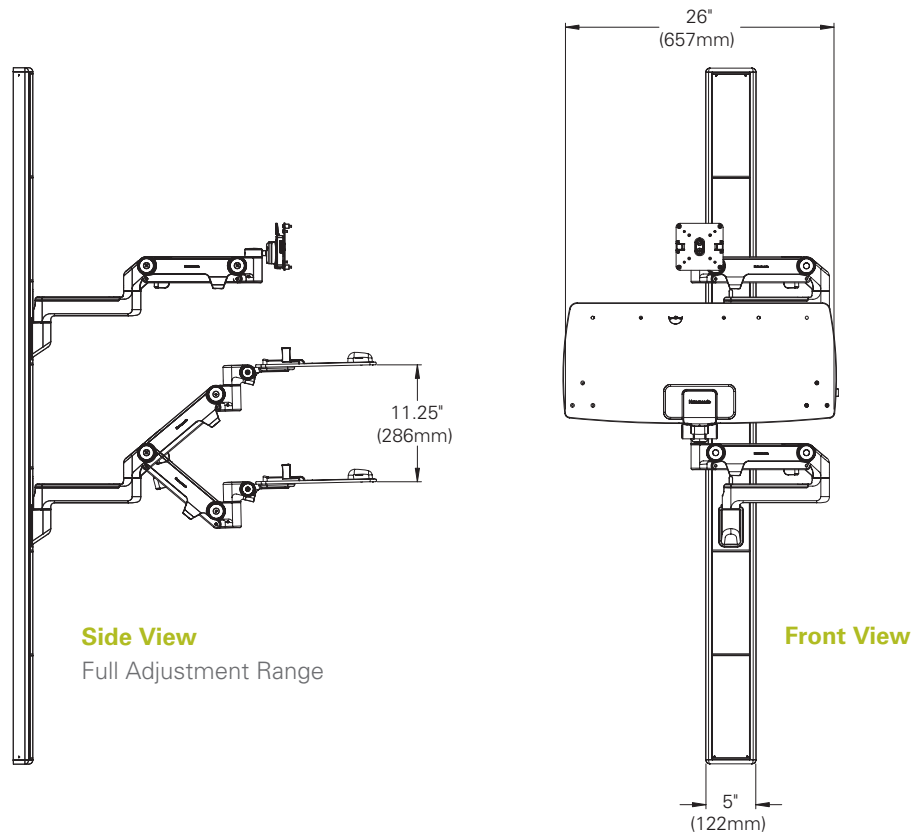

## Packaging Specs

### The V6 will be sent in two boxes:

- Components box (including monitor arm(s), keyboard trays and accessories): 27.6" H x 14.6" W x 7.1" D, 10 - 20 lbs. (dependent upon the components in the box)
- Track box: Dimensions and weight vary with track length. See below.
- 25 units per skid

### Master Carton Dimensions and Weights for V6 Track Lengths

27" Track	Dimensions: 29.9" H x 6.9" W x 4.9" D*	Weight: 6.2 lbs. (net weight); 7.9 lbs. (gross weight)*
37" Track	Dimensions: 39.8" H x 6.9" W x 4.9" D	Weight: 7.5 lbs. (net weight); 9.7 lbs. (gross weight)
47" Track	Dimensions: 50.0" H x 6.9" W x 4.9" D*	Weight: 9.0 lbs. (net weight); 11.7 lbs. (gross weight)*
57" Track	Dimensions: 59.8" H x 6.9" W x 4.9" D	Weight: 10.3 lbs. (net weight); 13.4 lbs. (gross weight)

### Accessory Mount Assembly

- Master Carton Dimensions: 17.9" H x 11.2" W x 9.3" D
- Master Carton Weight: 0.3 lb. (net weight); 28.0 lbs. (gross weight)
- Number of Pieces in Master Carton: 80

### 5 year warranty



\*Approximate

800.531.3746 • info@thehumansolution.com • thehumansolution.com

