

# Keyboard Accessories

Adjustable Keyboards - Accessories



## Accessories to complement your ergonomic arm and keyboard platform

Adjustable Corner Diagonal	Color	Model #	Weight
<ul style="list-style-type: none"> <li>- Converts 90° and curved corners (up to 9") to useable work areas.</li> <li>- Allows use of adjustable arm and keyboard platform when the natural corner of the worksurface does not permit it.</li> <li>- Adjusts to fit 1" to 2¼" thick worksurfaces.</li> <li>- Clamping design eliminates spacers, saving installation time.</li> <li>- Works with the Pinnacle 2 and Paramount arms.</li> <li>- Works with the following platforms: 2180S, 2181SN, 2100FT, 317RL, 2110D, 2110RL, 180</li> <li>- Dimensions: 12" W x 1¾" H</li> </ul>	Black	179ACD	3
<p><b>Compact Corner Diagonal</b></p> <ul style="list-style-type: none"> <li>- Converts 90° corners and diagonal corners less than 17" to usable work areas.</li> <li>- Moves operator closer to worksurface.</li> <li>- Designed specifically to fit model #321RL with Pinnacle 2 Arm.</li> <li>- Works with the Pinnacle 2 and Paramount arms.</li> <li>- Works with the following platforms: 188, 488, 2180S, 2181SN, 2100FT, 317RL, 2110D, 2110RL, 2110RLN, 321RL, 180, 187, 487</li> <li>- Dimensions: 17½" W x 1½" H</li> </ul>	Black	179CCD-1 1/2B	4
	Gray	179CCD-1 1/2G	4

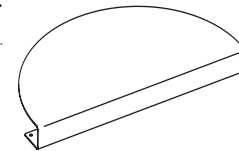
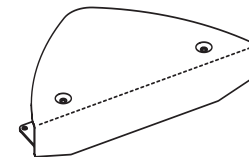

Continued on reverse...

At WorkRite we believe that every body has a right to work comfortably and safely for maximum productivity. You can trust WorkRite - as 75% of Fortune 100 companies have - to create innovative solutions that flex to the diverse range of user needs, preferences and settings at work today.

# Keyboard Accessories

Adjustable Keyboards - Accessories

## Corner Rectangle

	Color	Model #	Weight
<ul style="list-style-type: none"> <li>- Converts 90° corners and corners with keyboard cutouts to usable diagonal corners.</li> <li>- Works with all WorkRite keyboard arms.</li> <li>- Works with the following platforms: 188, 488, 2180S, 2181SN, 2100FT, 317RL, 2110D, 2110RL, 2110RLN, 321RL, 180, 187, 487, 383, 385RL, 386RL, 482, 483, 485, 486, 182, 183, 185, 186</li> <li>- Dimensions: 26" x 15" x 1½".</li> </ul>	Black	179CR	4
	Gray	179CR-G	4

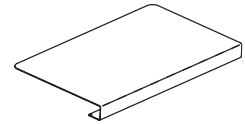

## Pinnacle 2 Arm No Positive Tilt Kit

<ul style="list-style-type: none"> <li>- For "no positive tilt" ergonomics applications.</li> <li>- No tools required to install.</li> <li>- Restricts PinnacleArm tilt to a range of 0° to -15°.</li> <li>- For use with all Pinnacle 2 Arms.</li> </ul>	3170-P2NPT	1
---	------------	---

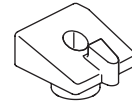

## Swivel Plate

<ul style="list-style-type: none"> <li>- Mounts between adjustable arm and platform.</li> <li>- Provides an additional 45° pivot point for extra adjustability and special storage or mounting requirements.</li> </ul>	2179-SP	2
---	---------	---

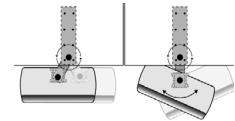

## Clip-On Mouse Palm Support

	Color	Palm Support		
<ul style="list-style-type: none"> <li>- Attaches to accessory mouse platforms</li> <li>- Supports wrist for ergonomic mousing</li> </ul>	Black	Jel	2120-25J	1
		No Jel	2120-25	1
<ul style="list-style-type: none"> <li>- Adds mouse support to the following products: Banana-Board® (2180S, 2181SN) Revo™ Platforms (2100FT) Mouse-Under™ Platforms (2110) Standard Platform with Slide (180S)</li> <li>- Easily clips on and off for storage</li> </ul>	Gray	Jel	2120-26J	1
		No Jel	2120-26	1



## Mounting Spacers

	Length		
<ul style="list-style-type: none"> <li>- For mounting adjustable arms when edge is thicker than the rest of the worksurface.</li> <li>- Select 16" or 21" length and desired thickness.</li> </ul>	16"	177-16-1/4	1
		177-16-1/2	1
		177-16-3/4	1
		177-16-1	1
		177-21-1/4	1
21"	177-21-1/2	1	
	177-21-3/4	1	
	177-21-1	1	

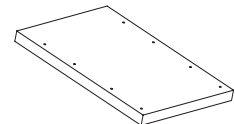

The following are federally registered trademarks of WorkRite Ergonomics: Stylized I®, and WorkRite Ergonomics®. The following are trademarks of WorkRite Ergonomics: JelRite™, LeatheRite™, Mouse-Forward™, Optimizer™ and Quick Ship Logo™.