

Acoustic Privacy Panel Mounting Hardware

ACU062

UPLIFT ACOUSTICS®

Package Contents



Flat-head screws
(qty 4)

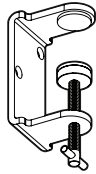

Clamp bracket
(qty 2)

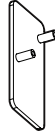

Support bracket
(qty 2)

To be used in conjunction with...

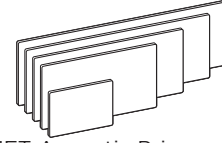

UPLIFT Acoustic Privacy Panels

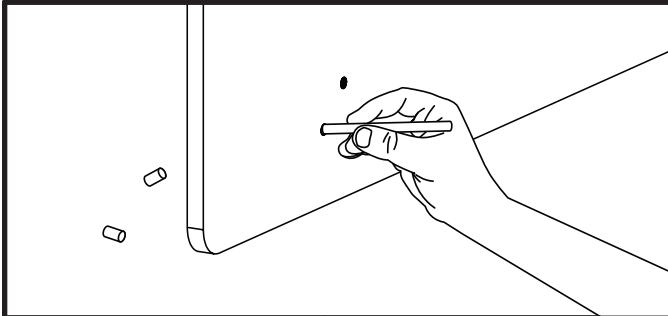

Step 1

On the Acoustic Privacy Panel, before attaching hardware, remove the material from the pre-cut holes with your fingertip or pencil. You should be able to spot these pre-cut holes near the bottom of the panel.

See next page for dimensions and hole locations. If you are installing a lot of panels, you may want to purchase our Acoustic panel hole template (ACU033).

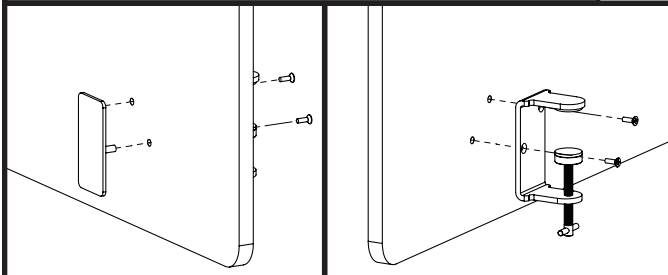

Step 2

Line up the pegs on the Support bracket with the holes on your Acoustic Privacy Panel, and push them inside so the Support bracket is flush with the panel. The long end of the Support bracket should point towards the floor as shown. From the other side, line the Clamp bracket up with those holes. Insert the Flat-head screws and tighten until snug. **Do not over tighten.**

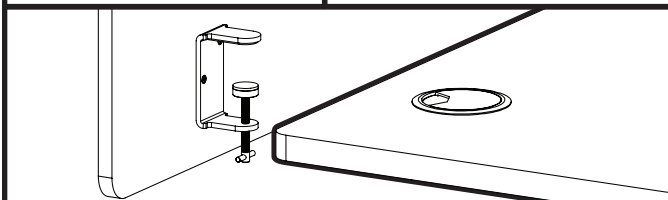

Step 4

Loosen both clamps so that the opening is wide enough to slide onto your desk. The included hardware will fit desktops between 0.75" and 1.75" thick.

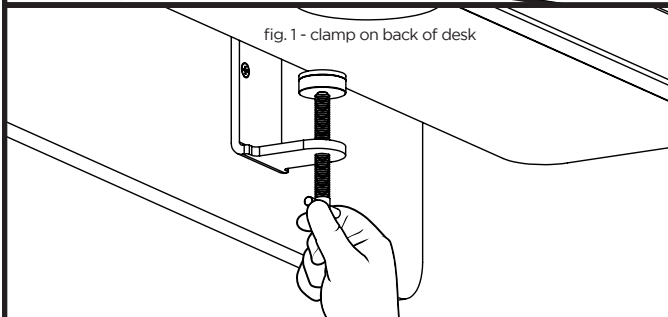

Step 5

Once on the back of the desk, center the panel and tighten the clamps onto your desktop (see figure 1).

Note: If you're attaching a Side Acoustic Privacy Panel, first slide the front clamp over the front of the Frame's Side bracket. Then, slide the back Clamp over the back of the Side Bracket. Once both clamps are around the bracket, center the panel and tighten the clamps over bracket (see figures 2 & 3).

figs. 2 - put clamp over front part first.

fig. 3 - put back clamp over back part of bracket, then tighten.

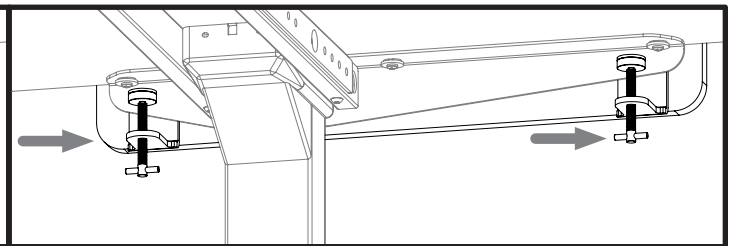
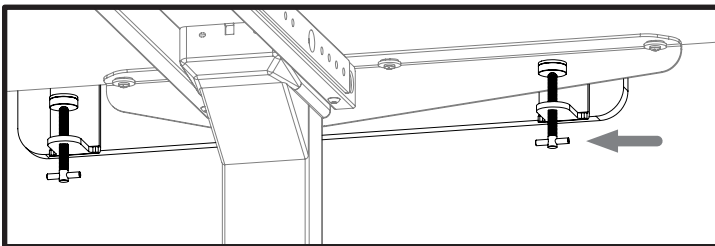

CAUTIONS & WARNINGS

CAUTION: Read all instructions before assembly. Failure to assemble properly may result in damage.

© UPLIFT Desk • 800-349-3839 • info@upliftdesk.com • upliftdesk.com

Acoustic Privacy Panel Dimensions

Side Panel

Each pair of the Side panel model's mounting holes are located 1.5" from each end, and 1.75" from the bottom.

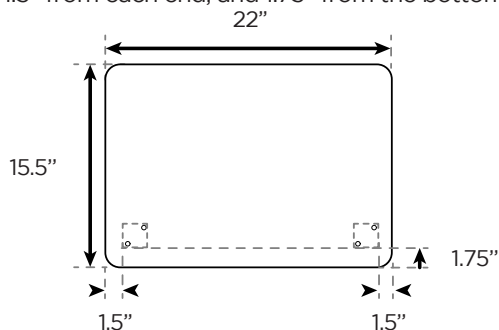

Side view - All models

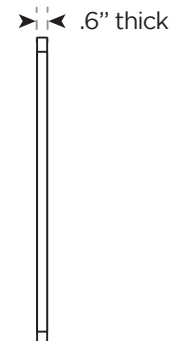

Back Panels

On every Back panel model, each pair of mounting holes are located 6.5" from each end, and 3.35" from the bottom.

40" model

40"

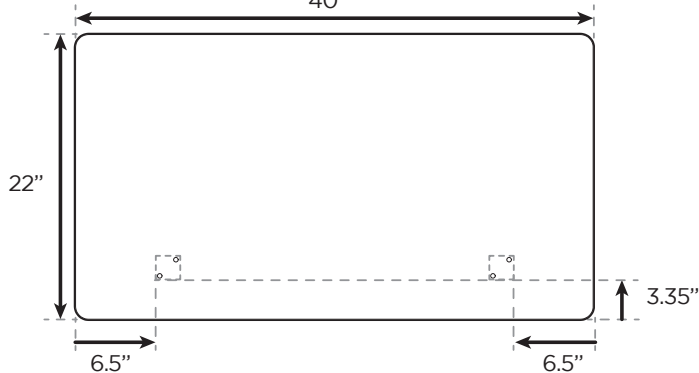

52" model

52"

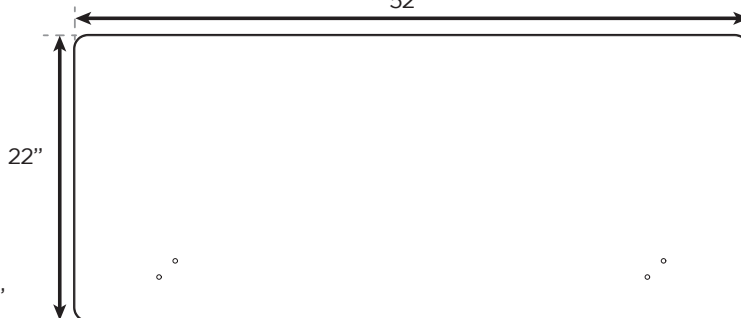

64" model

64"

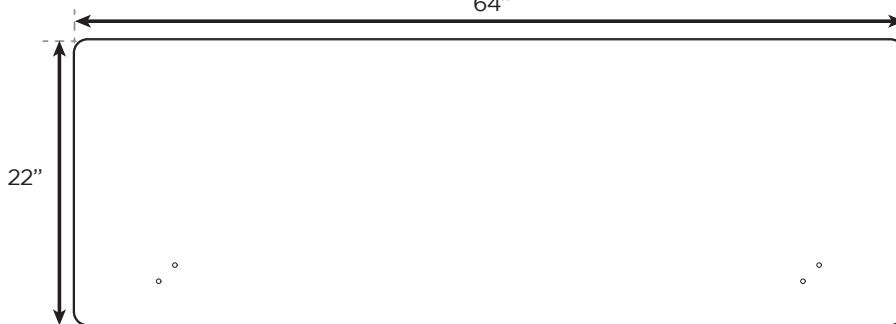

72" model

72"

