

# UPLIFT DESK<sup>®</sup>

E3 CPU Holder  
CPU001

## Package contents

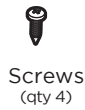

Screws  
(qty 4)



Washers  
(qty 4)

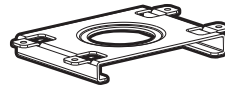

Mounting bracket

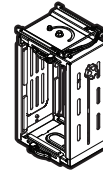

Main Unit

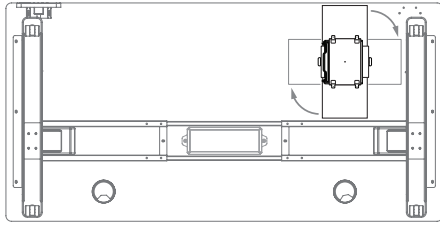

### \*Consider placement:

Decide if you want the CPU Holder mounted to the front or side of your desktop. Once installed, the CPU Holder will remain in this location and will swivel 180° to allow you access to your CPU's ports. Take a moment to find a place underneath your desk where you won't have any obstructions when rotating the CPU Holder.

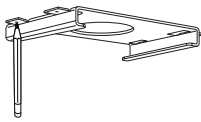

### Step 1

Hold the Mounting bracket under your desk at the location you've chosen, and mark the location of the four screw holes on your desktop.

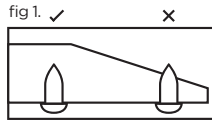

### Step 2

Using a drill with a 1/8" bit, drill pilot holes where the four marks are located. Drill no deeper than 1/2".

**CAUTION:** Do not drill through the desktop surface. Make sure screws aren't too long for your desktop thickness by holding the screw up to the desktop's edge. When using screws on a desktop with a center-cut ergo edge, make sure that the screw is not close to the ergo edge to avoid piercing the desktop with the screw. (see fig. 1)

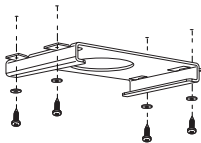

### Step 3

Install the Mounting bracket with the four (4) Screws and four (4) Washers.

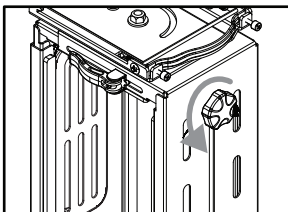

(a)

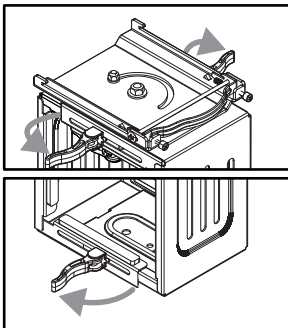
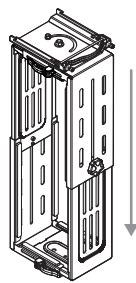

(b)



### Step 4

(a) Loosen the two knobs on the right and left side to adjust the height of the Main unit to accommodate your CPU.

(b) Unlatch the four (4) Lock levers to adjust the width of the Main unit to fit your CPU.

Note: If any of the Lock levers are too tight to open, you can loosen them slightly with a 2.5mm Allen wrench (not included). Once you release the Lock levers, you can rotate them counterclockwise to loosen them.

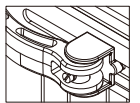

Next, expand the Main unit to its widest/tallest position.

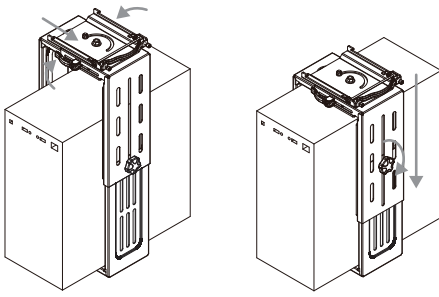

## Step 5

Insert your CPU tower. Carefully reverse the process in Step 4, close the width and height of the CPU Holder, tighten the knobs, and close the Lock levers to secure it inside.

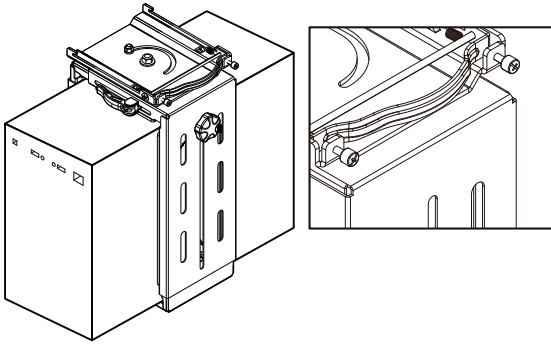

## Step 6

Look at the top of your unit. Align the CPU Holder's top bracket with the Mounting bracket installed underneath your desktop.

Unscrew the set screws to allow the spring-release handle to be pulled back to attach onto the Mounting bracket.

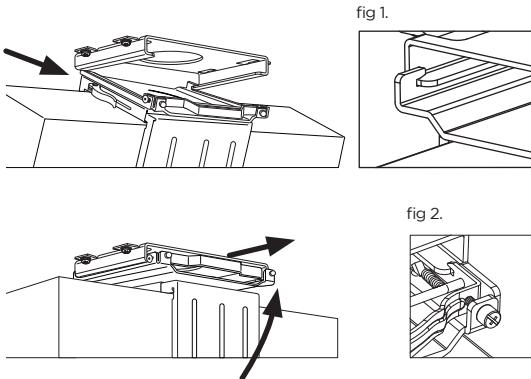

## Step 7

First, lift up the CPU Holder and carefully guide the hooks on the CPU Holder's top bracket onto the Mounting bracket. (see figure 1)

Then, lift the other side of the unit to the Mounting bracket while holding open the spring release handle. Lift into place and let go of the handle, locking it in. (**Note:** If the CPU is light enough, you may be able to push upwards without needing to pull out the handle). Ensure that the CPU Holder is firmly attached to the Mounting bracket.

**IMPORTANT:** Once secure, tighten the set screws on the handle, to prevent any accidental releasing of the CPU Holder. (see figure 2)

## Adjustment Guide

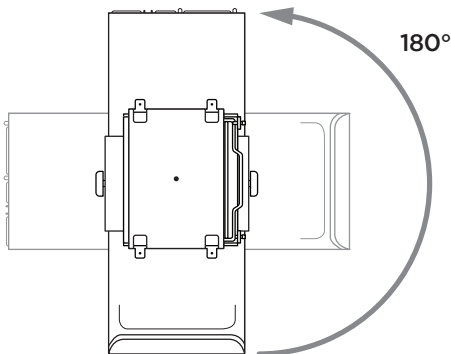

The CPU Holder rotates 180 degrees.



Read all instructions before installing. Failure to install properly may result in damage or personal injury.