

SINGLE MONITOR ARM

UPLIFT DESK®

UPL020

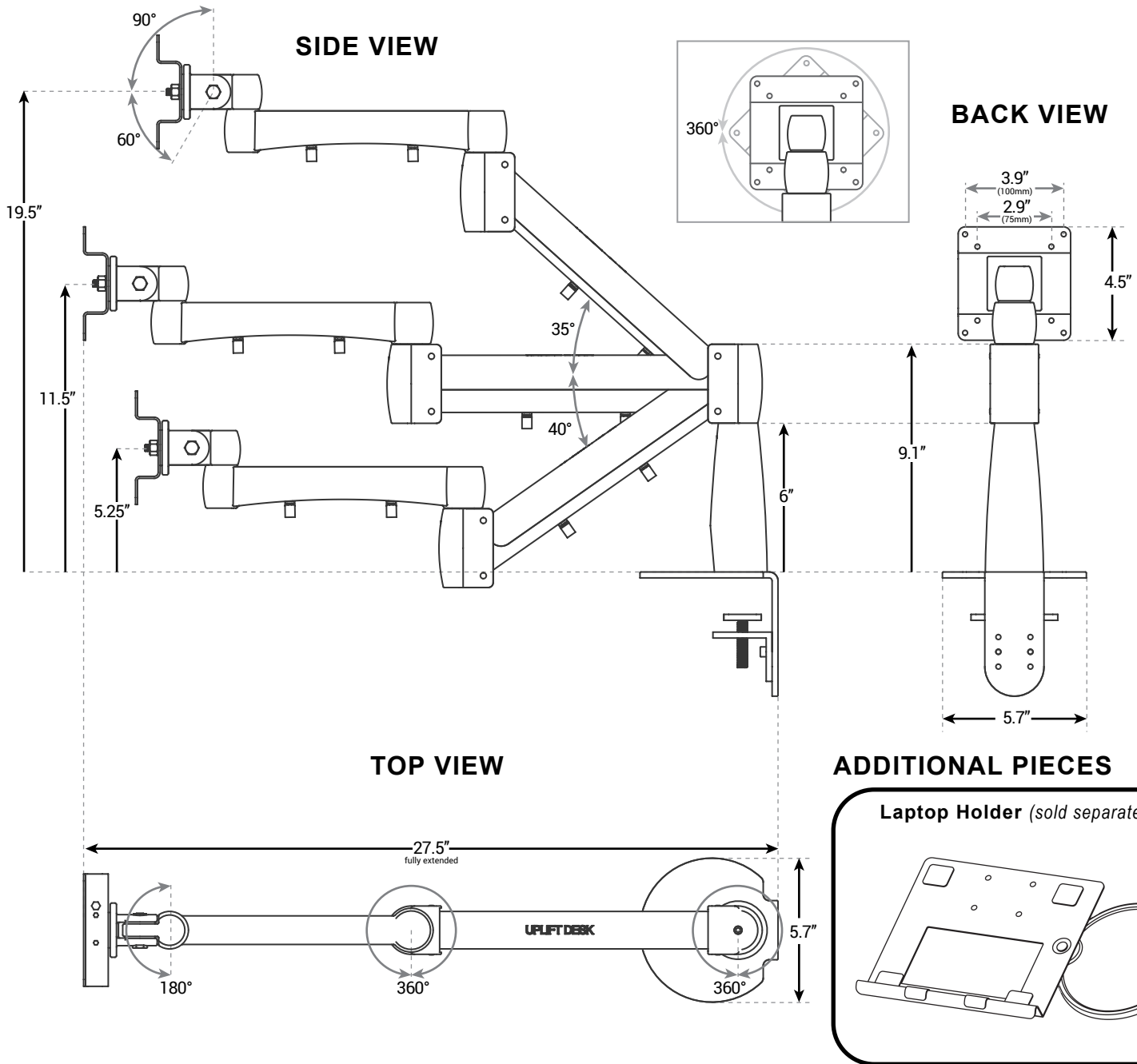

CAPABILITIES

| | |
|-------------------------|---|
| Height Adjustment Range | 14.25" H |
| Depth Adjustment Range | 27.5" D |
| Weight Capacity | 4.5 - 17.5 lbs |
| Display Rotation Range | 360° display rotation range 360° pan range |
| Monitor Compatibility | VESA 75mm & 100mm |
| Warranty | 5 Years |

FEATURES

- Two different adjustable gas cylinders available to support a wide variety of monitor weights
- Allows you to easily adjust the height, depth and tilt of your monitor
- In-line wire management minimizes cable clutter
- Large, stable clamp mount attaches to desks up to 3 5/8" thick