

UPLIFT DESK®

Front Clamp Standing Converter Instructions UDA118

Package contents

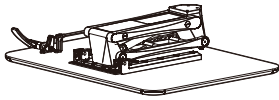

Main unit
(qty 1)

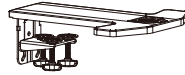

Clamp
(qty 1)

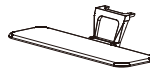

Keyboard Tray
(qty 1)



M6x25 bolts
(qty 4)



Allen wrench

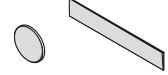

Tacky friction pads
(optional)

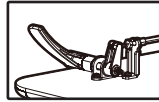

DO NOT activate this lever until step 3. Activating the lever before this step will release the gas-powered cylinder and cause the unit to rise quickly.

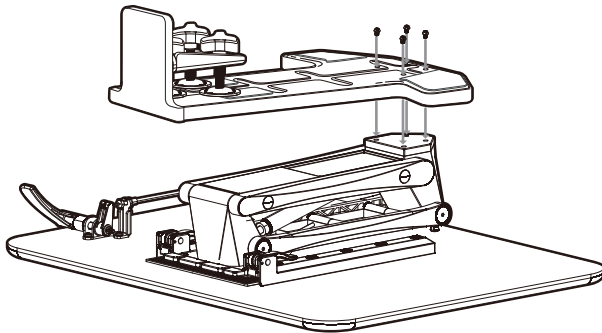

Step 1

Place the Main unit top-down on a flat and stable surface. Using two people, one person hold the Clamp in place as the other threads the M6x25 bolts into the Clamp onto the Main unit. Tighten with the Allen wrench.

Again, don't squeeze the paddle on the Main unit. It will release the gas-cylinder and cause it to rise quickly, possibly causing injury.

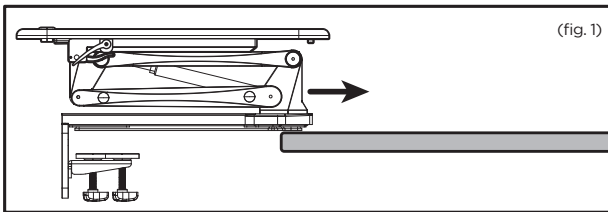

(fig. 1)

Step 2

With a friend's help, flip the assembly over and slide it over the edge of your desk, so that the Clamp is around the edge of your desk, with the Main unit on top of your desk. (see figure 1)

The Clamp's plate can be adjusted up and down to accommodate desks from .78" to 2.9" in thickness. Move it up for thinner desktops, and down for thicker desktops.

Once on the desk, screw the Clamp stoppers tight to secure the unit to your desk.

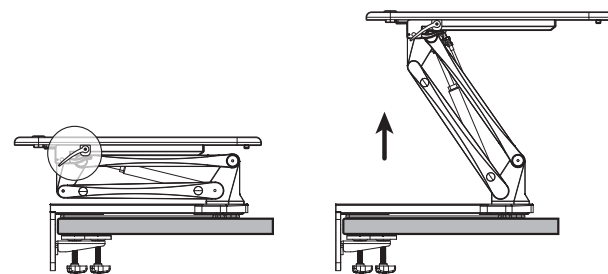
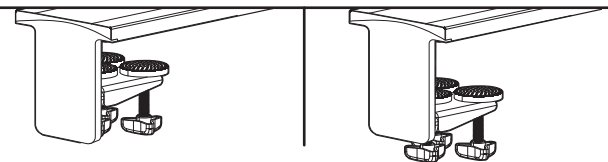

Step 3

Keep objects clear of the standing converter for this step.

To raise the converter, squeeze the paddle. It is advised you hold onto it with two hands as you raise (and lower) the worksurface.

This will allow you to adjust the converter and move it to your desired positions. Release the paddle to lock into place.

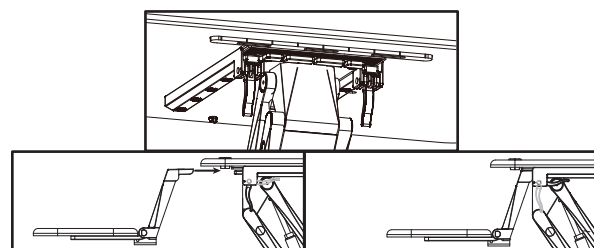

Step 4

Undo the latches on both sides of the Main unit.

When in the unlatched position, slide the Keyboard tray onto the Main unit.

Flip the latches back up. This will secure and lock the tray onto the unit.

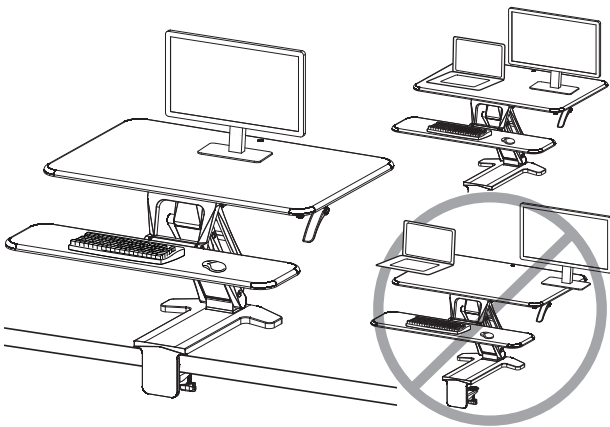

Step 5

Once the converter is fully assembled, you can start adding your devices and accessories to the upper worksurface.

Use the optional Tacky friction pads to increase friction of the devices on the worksurface. Simply place them under your monitors or laptops to help prevent movement. Helpful Tip: Tacky friction pads are reusable. Use water to wipe clean and reapply where needed.

Make sure your things are centered on the upper worksurface. Do not place items on the edge where they could fall or throw off the balance of the converter.

Leave enough slack in your cables to allow for the converter to raise and lower. If cables are too short they can snag and pull items off your worksurface.

Adjustment Guide

In it's lowest position, the upper worksurface sits 6.5" from the desk surface.

In it's highest position, the upper worksurface sits 16.7" from the desk surface.

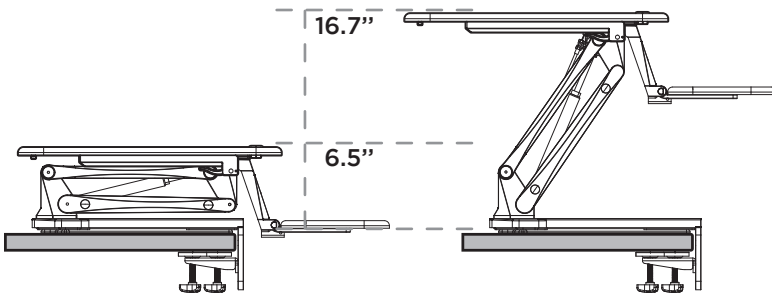

When not in use, flip the tray up to store it so that it is out of the way.

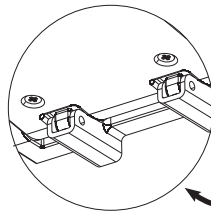

The Keyboard tray rests flat at 0°.

Flip up the tabs underneath the tray, and the tray will rest at 8°.

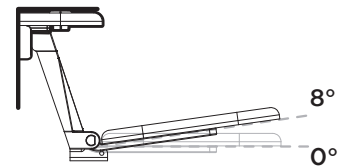

CAUTION: Read all instructions before assembly. Failure to assemble properly may result in damage or personal injury.



CAUTION: Keep hands clear during operation! Do not reach into the mechanism near the gas spring, or near the supporting bars.



CAUTION: The maximum load capacity of the unit is 33 lbs for the upper worksurface and 4 lbs for the keyboard tray. Do not overload.



CAUTION: Keep devices centered and away from the edge of the main worksurface, to prevent them from falling.



CAUTION: Make sure that the wires for your devices have enough slack. This will prevent your devices from being pulled off the unit workstation when raising the unit.



CAUTION: When relocating the unit, remove all devices to avoid harm or damage, and adjust the unit to its lowest position.



CAUTION: When moving, move it carefully with two people, to avoid injury and damage to the product and surroundings.

© **Copyright Notice:** These instructions are a component of the UPLIFT Front Clamp Standing Converter. These instructions are part of the scope of delivery, even if the item is resold. These instructions are also available on the UPLIFT Desk website: upliftdesk.com. Excerpts or copies may not be forwarded to third parties or used in any other published form without the prior written consent of UPLIFT Desk. These instructions are subject to United States copyright law.