

UPLIFT DESK®

Mobile Standing Coverter Instructions UDA120

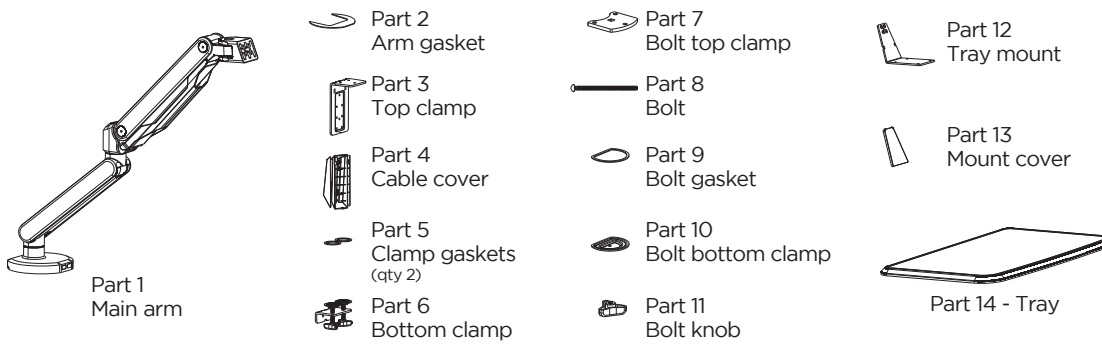

Screws

- Part A M6x12mm screws (qty 3)
- Part B M6x12mm screws (qty 8)
- Part C M6x14mm screws (qty 2)

Tools

- Allen wrench (small)
- Allen wrench (large)

There are two ways to attach your UPLIFT Desk Mobile Standing Converter to your desktop: Clamp and bolt-thru assembly.

Clamp Assembly - Attach the arm to the back of your desk....

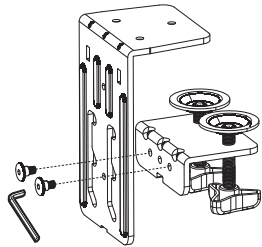

Clamp Step 1

Connect the Bottom clamp (part 6) to the Top clamp (part 3) by using M6x14mm (part C) and the small Allen wrench.

Select the appropriate mounting holes per the thickness of your desk.

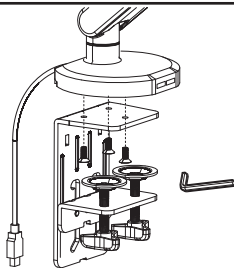
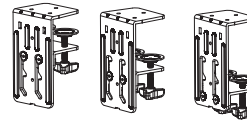

Clamp Step 2

Connect the Top clamp (part 3) to the Main arm using the three M6x12mm screws (part A) and the small Allen wrench.

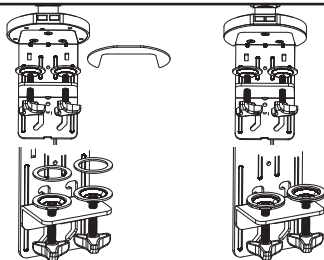

Clamp Step 3

Place the Arm Gasket (part 2) under the arm mount, and the Clamp gaskets (part 5) to the Bottom clamp (part 6).

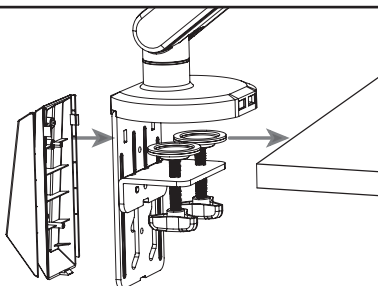

Clamp Step 4

Turn the knobs counterclockwise to loosen them.

Slide the assembly onto your desk and turn the knobs clockwise to tighten the clamp to the desk. **Make sure that the clamp is secure. If the clamp is too loose, the unit may wobble or fall.**

Snap the Cable cover (part 4) to the back.

Bolt-Thru Assembly - for holes 8.5mm to 70mm



Bolt-Thru Step 1

Insert the Bolt (part 8) into the Bolt top clamp (part 7)

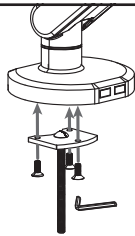

Bolt-Thru Step 2

Connect the assembly to the Main arm using the three M6x12mm screws (part A) and the small Allen wrench.

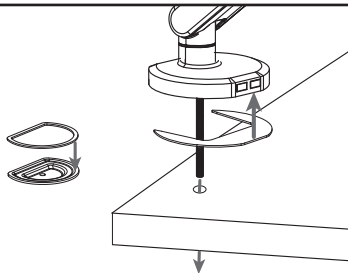

Bolt-Thru Step 3

Place the Arm gasket (part 2) under the arm's mount, and apply the place the Bolt gasket (part 9) onto the Bolt bottom clamp (part 10) as shown.

Slide the arm assembly into the hole on your desk.

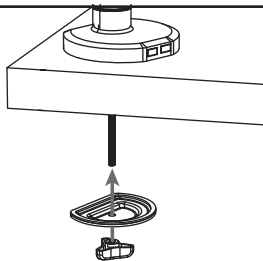

Bolt-Thru Step 4

Slide the Bolt bottom clamp (part 10) over the screw, then screw on the Bolt knob (part 11) and tighten, to keep the Main arm securely fastened to the desk. **Make sure that the clamp is secure. If the clamp is too loose, the unit may wobble or fall.**

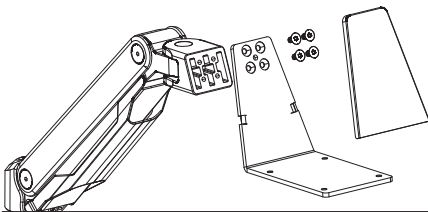

Step 2

Connect the Tray mount (part 12) to the Main arm using four M6x12mm screws (part B) and tighten with the small Allen wrench (part 18).

Affix the Mount cover (part 13) as shown.

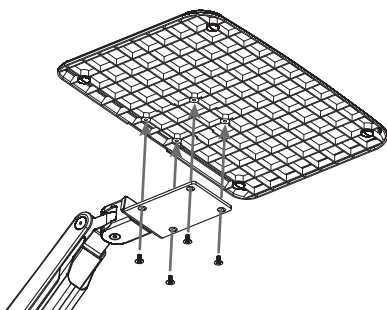

Step 3

Connect the Tray (part 14) to the Tray mount (part 12) using four M6x12mm screws (part B) and tighten with the small Allen wrench.

Cord Management

The UPLIFT Desk Mobile Standing Converter allows you to run cables from your tray, down the arm, and to the back of your desk.

- Pull the four tabs out of the cable cover on the upper section of the arm.
- Pull up and out on the cable cover on the lower section of the arm.
- Run your cables through the exposed section of the arm. **Make sure that there is some slack in the cables to allow the arm to freely move.**
- Trap the cables under the cable cover on the upper section of the arm and snap it back into place, and slide the cable cover over the wires in the lower section of the arm.

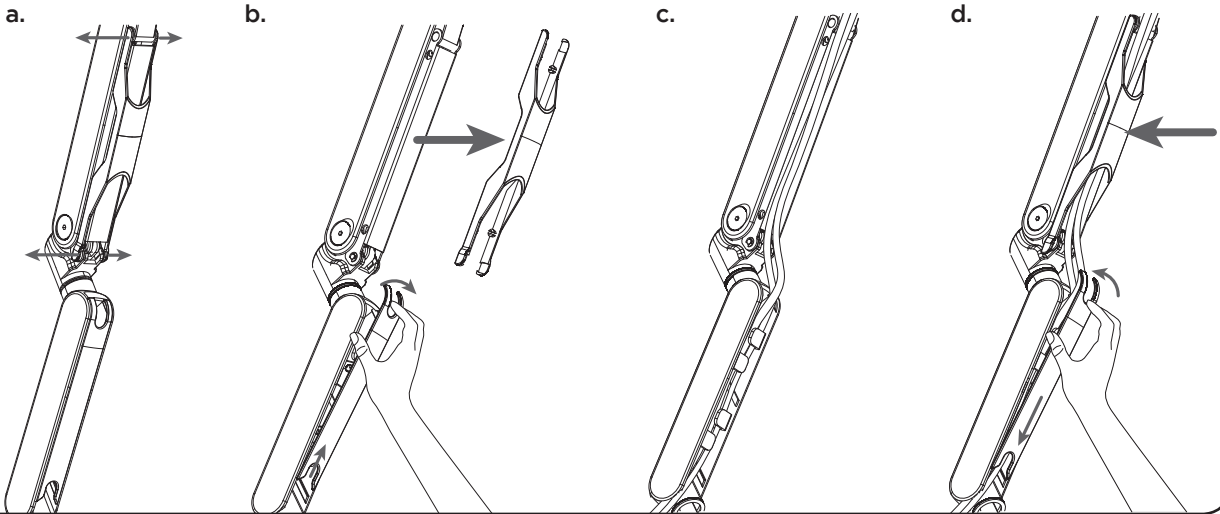

Moving the arm, and counterbalancing

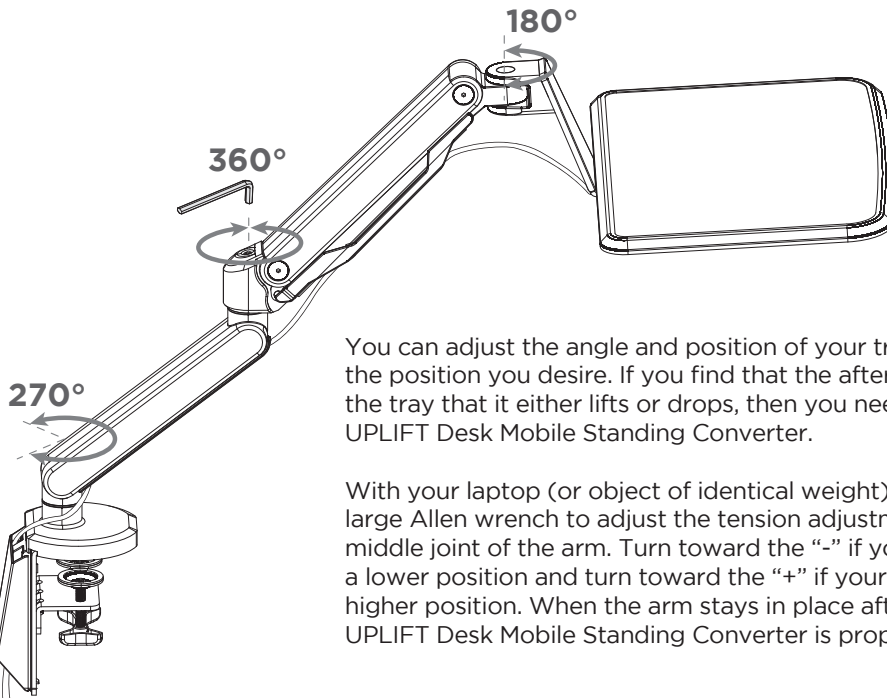

You can adjust the angle and position of your tray by simply moving it to the position you desire. If you find that the after you place your laptop on the tray that it either lifts or drops, then you need to counterbalance your UPLIFT Desk Mobile Standing Converter.

With your laptop (or object of identical weight) on the tray, use the large Allen wrench to adjust the tension adjustment screw located at the middle joint of the arm. Turn toward the “-” if your arm will not adjust to a lower position and turn toward the “+” if your arm will not adjust to a higher position. When the arm stays in place after you’ve adjusted it, your UPLIFT Desk Mobile Standing Converter is properly counterbalanced.

CAUTION

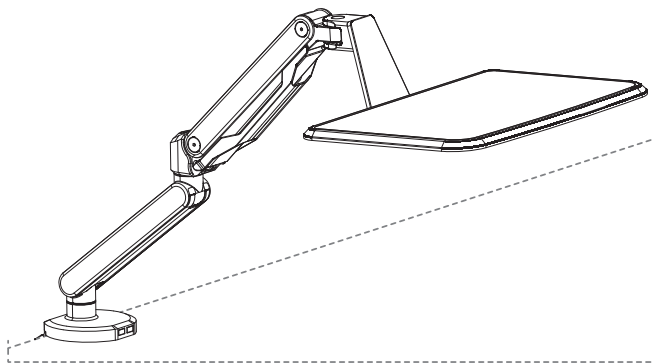

- The maximum load capacity of the UPLIFT Desk Mobile Standing Converter is 15.4 lbs. **Do not overload.**
- Leave cables slack in the arm assembly to allow the arm room to adjust.
- Secure all clamps and mounts to a stable desktop.
- NOT A CHILD'S TOY. Children under 12 must be supervised by an adult while using UPLIFT Desk Mobile Standing Converter.
- Failing to follow these assembly instructions and safety precautions may result in personal injury.
- Failing to follow these assembly instructions and safety precautions voids your warranty and may result in property damage.

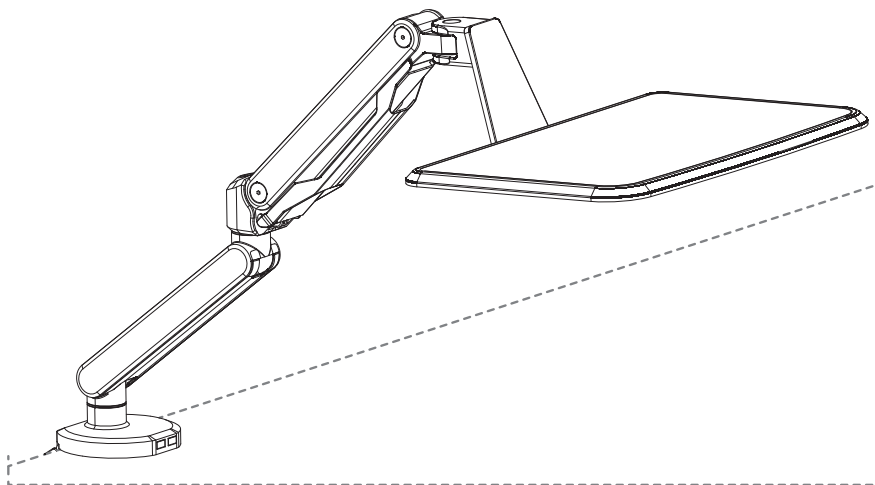

UPLIFT[®] DESK[®]

Mobile Standing Converter

©

Copyright Notice: These instructions are a component of the UPLIFT Desk Mobile Standing Converter. These instructions are part of the scope of delivery, even if the item is resold. These instructions are also available on the UPLIFT Desk website: upliftdesk.com. Excerpts or copies may not be forwarded to third parties or used in any other published form without the prior written consent of UPLIFT Desk.

These instructions are subject to United States copyright law.