

Lady Bird Standing Desk Converter

SKU: UDA124

UPLIFT DESK

Package Contents

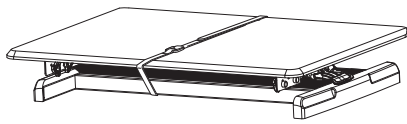

Main unit

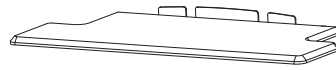

Keyboard tray



Tray brackets
(qty 2)



Screws
(qty 6)



Pads
(qty 4)



Plastic zip tie
(qty 2)

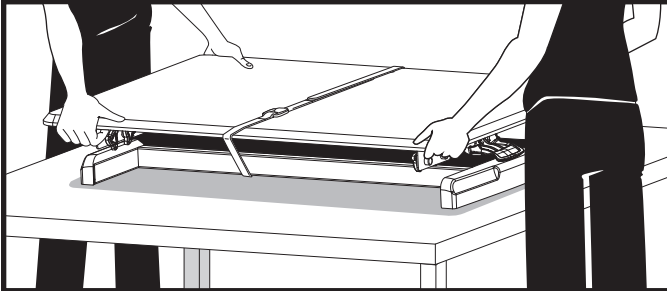

Step 1

The Lady Bird Desk Converter needs to sit on a surface that's at least 30" wide x 27" deep. Clear off a surface and, with one other person to help you, lift the Main unit and set it in place.

The Main unit ships with a hook-and-loop band, which keeps it secure during shipment. Simply unfasten and remove.

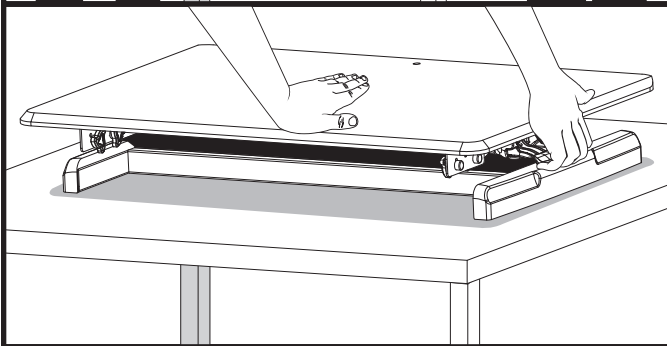

Step 2

You will need to raise the Main unit to a higher position to attach the keyboard tray. Place your left hand flat on the top surface, which will help support and stabilize the converter as you raise it. Grip the handle on the right side, squeeze, and lift.

Please remember to hold the desk converter top firmly. If you don't secure the top while guiding it up, it could raise quickly, potentially causing injury during set-up.

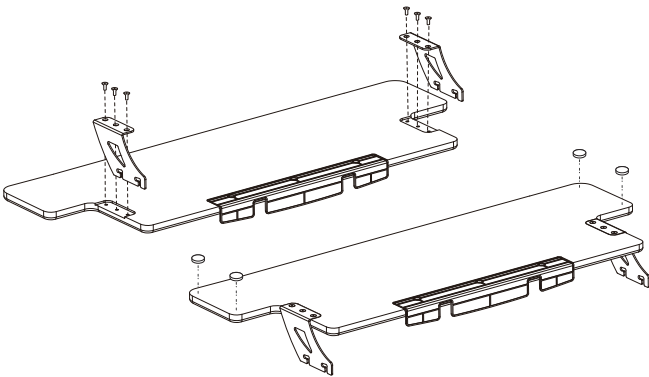

Step 3

Note: Do not overtighten the screws. Only tighten them until the screw heads are flush with the Tray brackets. Going any tighter may strip the screws and damage the Keyboard tray.

Turn the Keyboard tray upside down and attach the Tray brackets to the Keyboard tray. Use the included Screws and a Phillips head screwdriver.

Then, peel off the backing and apply the Pads to the four corners of the Keyboard tray.

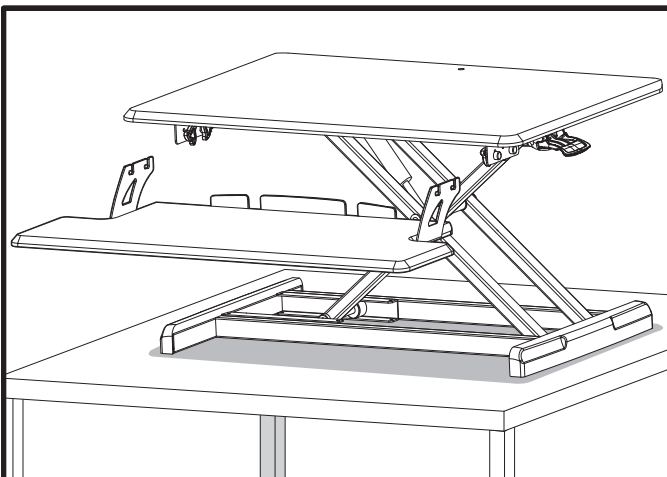

Step 4

Hang the keyboard tray assembly on the knobs and, once in place, tighten.

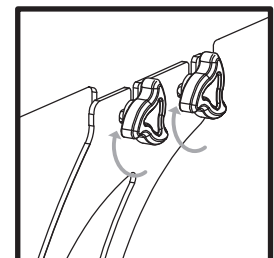
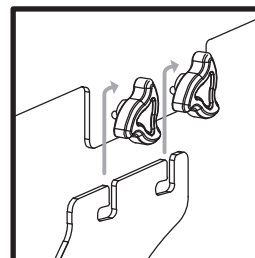

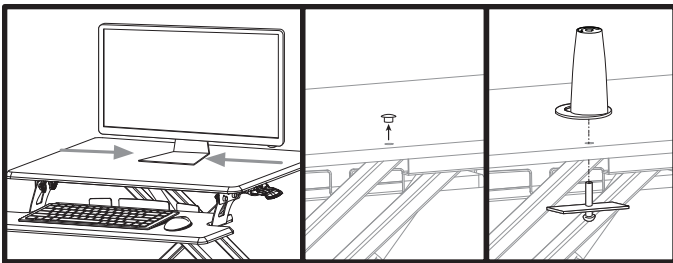

Step 5

You can now add your devices and work items to the unit. Keep them centered and away from the edge of the main work surface, to prevent accidents.

If you want to install a Bolt-through monitor arm, remove the plug at the back. Then follow the monitor arm's instructions for its Bolt-through mount.

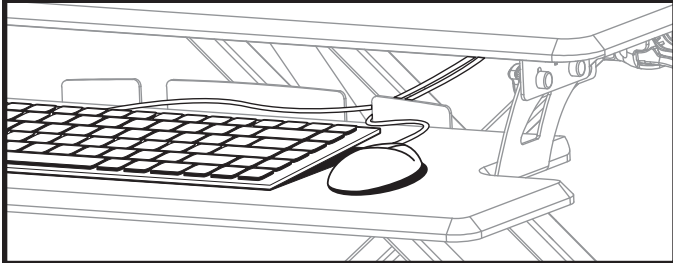

Step 6

Be mindful of the wires on and around your workstation. Make sure you keep them clear from the cross joints and moving parts of the Desk converter, to prevent them from getting pinched and damaged.

There are two wire management gaps on the Keyboard tray backboard. We recommend using the one on the right side, since this will keep the wires away from the sliding parts of the raising mechanism. Under the main work surface, you can run your mouse and keyboard wires between the pneumatic wire and the main work surface.

Use the included zip ties, where necessary, to gather your cables together.

If the wires running from your Desk converter are connected to a CPU farther away, or plugged into the wall, make sure that the wires have enough slack to allow for the full range of the Converter's vertical motion (max 16.9" height) this will prevent the wires from pulling tight and yanking your devices off the work surface.

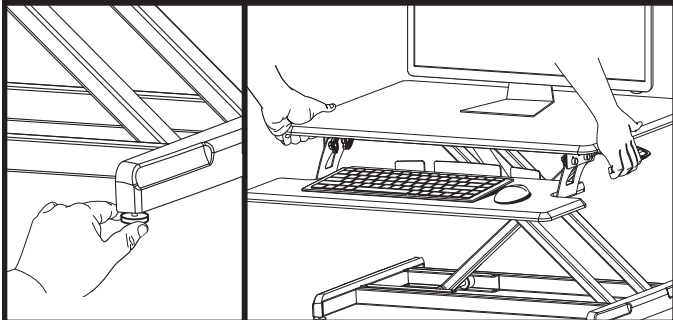
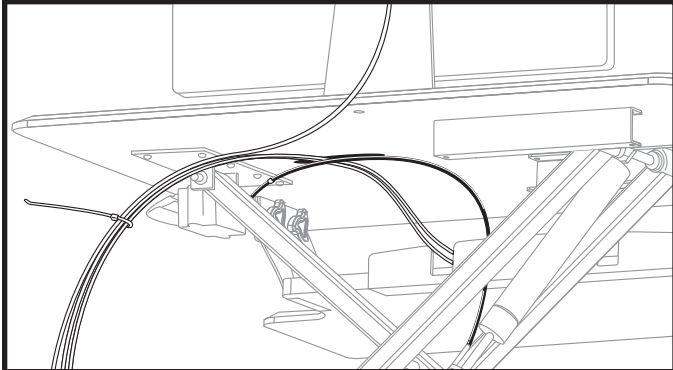

Step 7

If the Converter is resting on an uneven surface and you need to adjust how it sits, there are adjustable leveling studs under each corner.

Squeeze the handle, while firmly holding the left side of the top surface, and guide the Converter down.

Note: Don't hold the Keyboard tray to guide the surface up or down. This will help you avoid getting your fingers caught between the tray and your table surface.

⚠ CAUTIONS & WARNINGS

- ⚠ **CAUTION:** Read all instructions before assembly. Failure to assemble or operate properly may result in damage or personal injury.
- ⚠ **CAUTION:** Be mindful of the wires on and around your workstation. Keep them clear from the cross joints and moving parts to prevent them from getting pinched or damaged.
- ⚠ **CAUTION:** Keep hands clear during operation! Do not reach into the mechanism or near the gas spring when in motion or while adjusting height.
- ⚠ **WARNING:** The maximum load capacity of the upper work surface is 28.6 lb (13 kg), and about 4.4 lb (2 kg) for the keyboard tray. Do not overload.
- ⚠ **CAUTION:** Do not apply force greater than maximum load capacity. Always squeeze the handle when lowering; failure to do so will put undue stress on the components.
- ⚠ **WARNING:** Keep devices centered and away from the edges to prevent them from falling.
- ⚠ **WARNING:** Make sure that the wires for your devices have enough slack to allow for the full range of movement (max 16.9" height). This will prevent your devices from being pulled off the work surface when raising the unit.
- ⚠ **CAUTION:** When moving the unit, adjust it to its lowest position, remove all devices, and move it carefully with two people, to avoid injury and damage to the product and surroundings.