

UPLIFT DESK[®]

UPLIFT Adapt X™ Instructions UDA110

Package contents

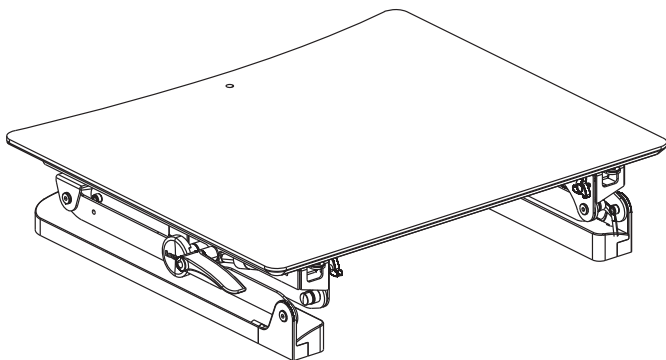

Main unit

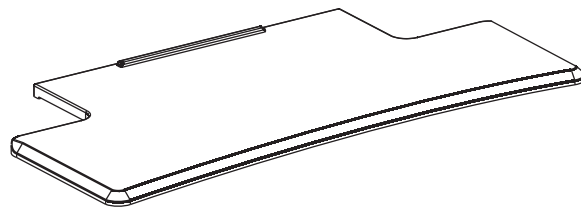

Keyboard tray

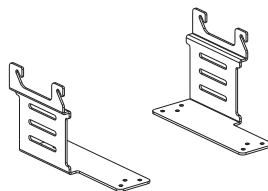

Tray brackets
(qty 2)



Hinge cover
(qty 2)



Screws
(qty 8)

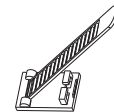

Cable mounts
(qty 4)

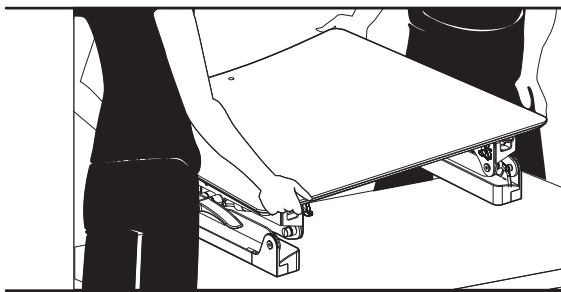

Step 1

Unpack the box and verify the contents against the parts above. Clear off the surface you intend to use the Adapt X™ on, and ensure there is at least 29" w by 24" d space for it. Two people should lift the main unit and place it on the intended surface.

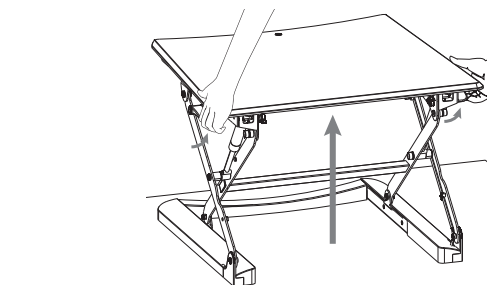

Step 2

Raise the Adapt X™ main unit to a higher position so that you can easily access the space underneath, to later attach the keyboard tray. Grip the handles on either side of the upper worksurface, squeeze, and lift.

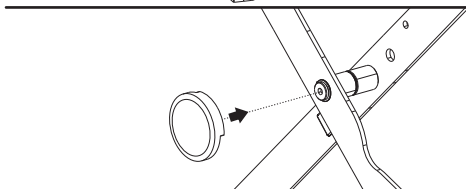

Step 3

Attach a hinge cover to each connecting arm as pictured.

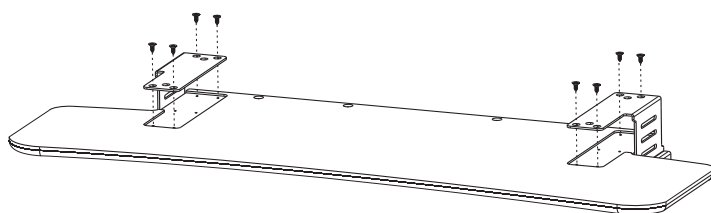

Step 4

Using a Phillips head screwdriver, connect the tray brackets to the keyboard tray using the included screws.

Note: Tighten the screws only until the head is flush with the tray brackets. Going any tighter may strip the screw and damage the keyboard tray.

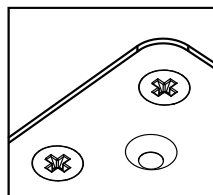

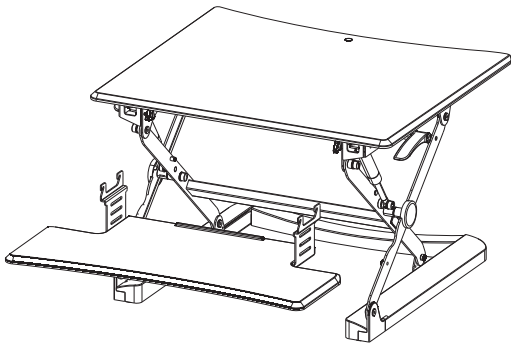

Step 5

Hang the keyboard tray assembly on the knobs, and once in place, tighten.

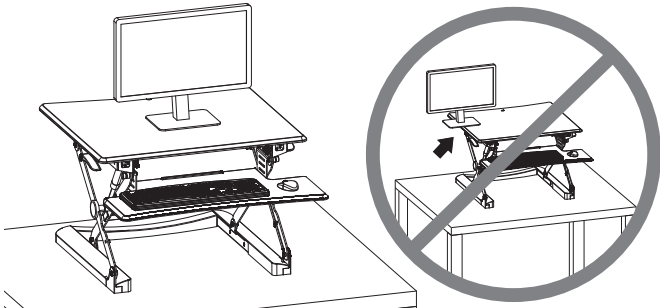
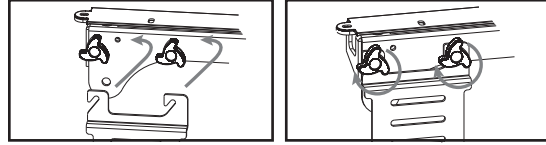

Step 6

You can now add your devices and work items to the Adapt X™. Keep them centered and away from the edge of the main worksurface, to prevent them from falling.

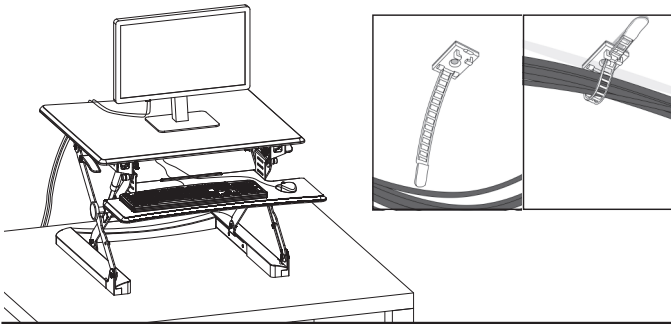

Step 7

Be mindful of any wires your devices may have: keep them clear of the cross joints of the main unit. The cable mounts can be placed to organize wires and keep them from hanging down. Make sure that there is enough slack in the wires to allow the Adapt X™ to raise and lower without pulling your devices off the work surface.

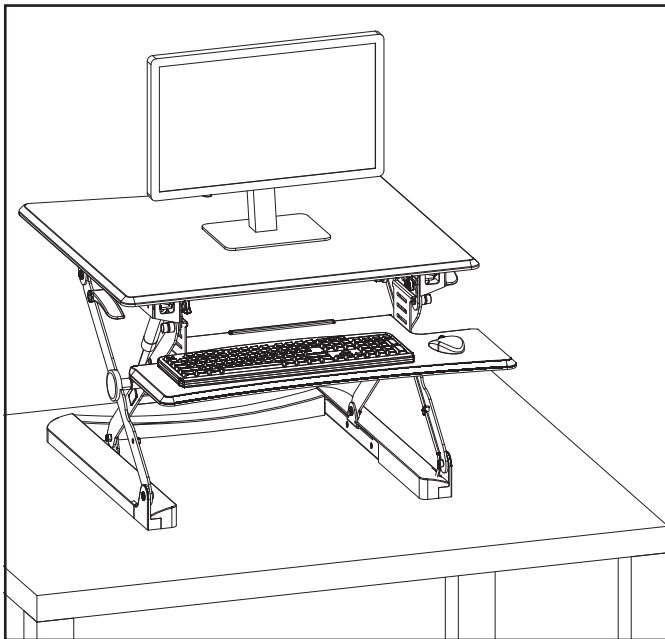

Please note

- Keep hands clear during operation! Do not reach into the mechanism near the gas spring.
- The maximum load capacity of the UPLIFT Adapt X™ is 33 lbs. for the upper worksurface and 4.25 bs for the keyboard tray. Please do not overload.
- Keep devices centered and away from the edge of the main worksurface, to prevent them from falling.
- Make sure that the wires for your devices have enough slack. This will prevent your devices from being pulled off the Adapt X™ workstation when raising the unit.
- When moving, adjust the unit to its highest position, remove all devices to avoid harm or damage.
- When moving, move it carefully with two people, to avoid injury and damage to the product and surroundings.

© **Copyright Notice:** These instructions are a component of the UPLIFT Adapt X™. These instructions are part of the scope of delivery, even if the item is resold. These instructions are also available on the UPLIFT Desk website: upliftdesk.com. Excerpts or copies may not be forwarded to third parties or used in any other published form without the prior written consent of UPLIFT Desk.
These instructions are subject to United States copyright law.